

SKETCH/AREA TABLE ADDENDUM

DATE **NOVEMBER 23 2009**

RE # **2456909**

PARCEL ID **24 352750 B 10**

CITY **COCOA**

COUNTY **BREVARD**

STATE **FL**

ZIP **32926**

PERMIT # **PICTO REVIEW**

MARKET AREA **06**

ADDRESS **551 CRESSA CIR**

APPRAISER NAME **JCT/DWL**

BRANCH OFFICE **Viera**

SUBJECT

IMPROVEMENTS SKETCH

5/28/2004

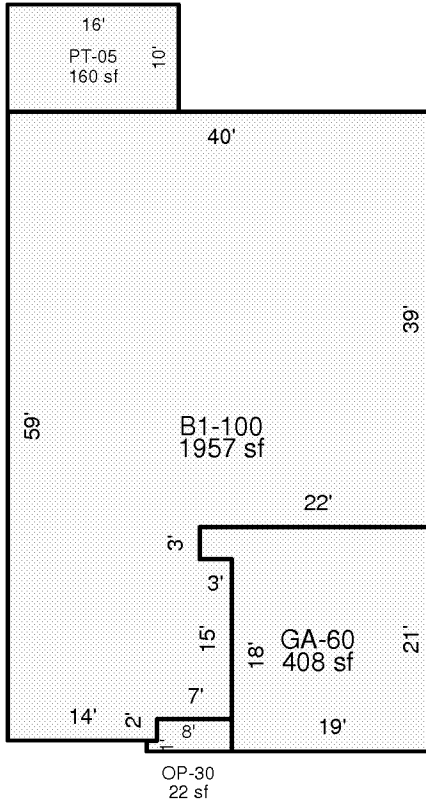

Scale: **1 = 18**

AREA CALCULATIONS

AREA CALCULATIONS SUMMARY

Code	Description	Factor	Net Size	Perimeter	Net Totals
B1	B1-100	1.00	1957	204	1957
PT	PT-05	1.00	160	52	160
OP4	OP-30	1.00	22	22	22
GA7	GA-60	1.00	408	86	408

Comment Table 1

--

Comment Table 2

Comment Table 3

--	--