

# SKETCH/AREA TABLE ADDENDUM

Date 19 AUG. 2009

RE # 2456877

Parcel ID 24 352750 A 44

City COCOA

County BREVARD

State FL

Zip 32926

Permit # NONE

Market Area 07

Address 732 CRESSA CIR.

Appraiser Name WHS

Branch Office TITUSVILLE

SUBJECT

IMPROVEMENTS SKETCH

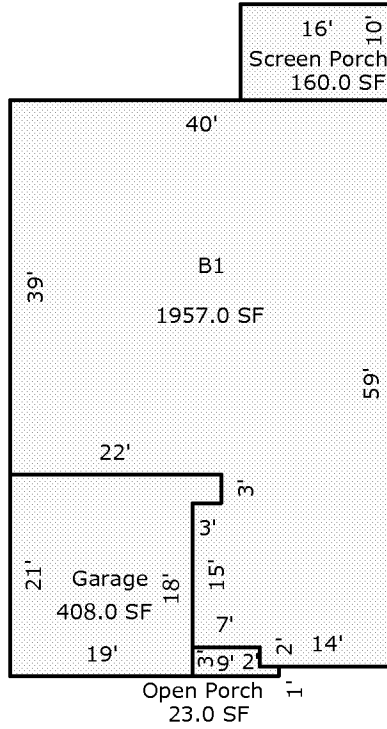

Scale: 1 = 20

### AREA CALCULATIONS SUMMARY

Code	Description	Factor	Net Size	Perimeter	Net Totals
B1	B1	1.00	1957.0	204.0	1957.0
GA	Garage	1.00	408.0	86.0	408.0
OP	Open Porch	1.00	23.0	24.0	23.0
SP	Screen Porch	1.00	160.0	52.0	160.0

#### Comment Table 1

--	--

#### Comment Table 2

#### Comment Table 3

--	--

AREA CALCULATIONS