

SKETCH/AREA TABLE ADDENDUM

DATE DECEMBER 9 2009

RE # 2444322

SUBJECT

PARCEL ID	24-36-08-00-545	COUNTY	Brevard	STATE	FL	ZIP	32926
CITY	COCOA	PERMIT #	PICTO REVIEW				
MARKET AREA	06	ADDRESS	180 CITY POINT RD				
APPRAISER NAME	RDK/DWL	BRANCH OFFICE	Merritt Island				

IMPROVEMENTS SKETCH

SHED NV

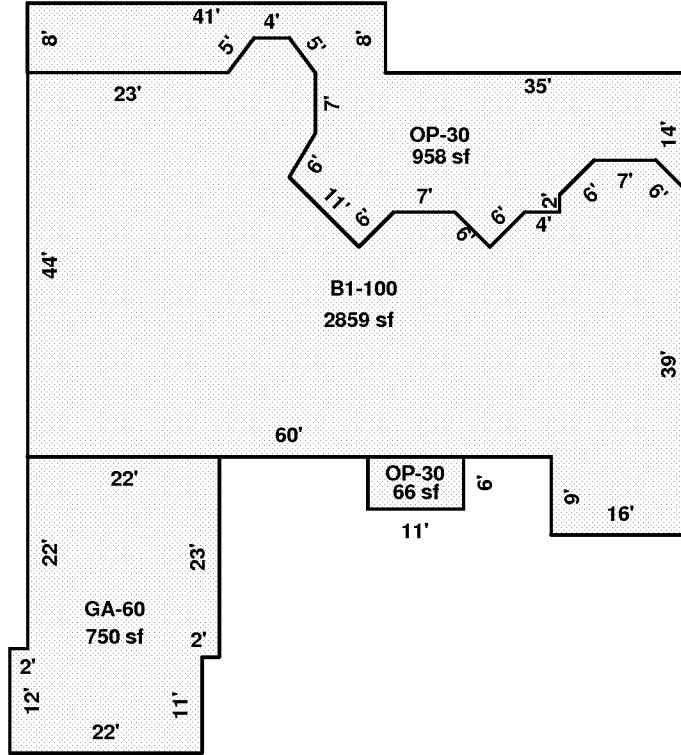

Scale: 1 = 22

AREA CALCULATIONS

AREA CALCULATIONS SUMMARY

Code	Description	Factor	Net Size	Perimeter	Net Totals
B1	B1-100	1.00	2859	277	2859
OP4	OP-30	1.00	958	215	
	OP-30	1.00	66	34	1024
GA7	GA-60	1.00	750	116	750

Comment Table 1

--	--

Comment Table 2

Comment Table 3

--	--