

SKETCH/AREA TABLE ADDENDUM

DATE 7-6-11

RE # 2440746

SUBJECT

PARCEL ID	243735CI 21 13		
CITY	COCOA BEACH	COUNTY	Brevard
		STATE	FL
		ZIP	32931
PERMIT #			
MARKET AREA	17	ADDRESS	132 SUWANNEE LN
APPRAISER NAME	DZC	BRANCH OFFICE	TITUSVILLE

IMPROVEMENTS SKETCH

new drawing on page 2 for addition

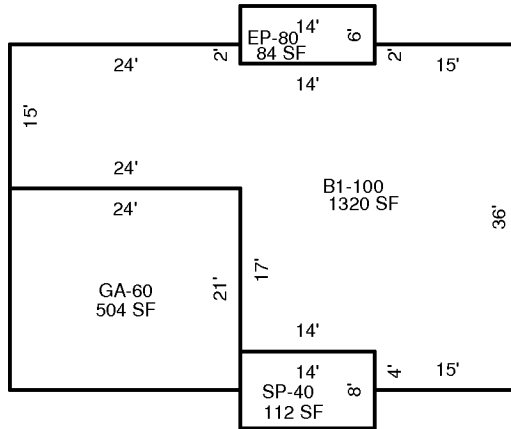

Scale: 1" = 12'

AREA CALCULATIONS

AREA CALCULATIONS SUMMARY

Code	Description	Factor	Net Size	Perimeter	Net Totals
B1	B1-100	1.00	1320	182	1320
EP5	EP-80	1.00	84	40	84
SP4	SP-40	1.00	112	44	112
GA7	GA-60	1.00	504	90	504

Comment Table 1

--	--

Comment Table 2

Comment Table 3

--	--

SKETCH/AREA TABLE ADDENDUM

DATE 7-6-11

RE # 2440746

SUBJECT

PARCEL ID	243735CI 21 13		
CITY	COCOA BEACH	COUNTY	Brevard
		STATE	FL
ZIP	32931		
PERMIT #			
MARKET AREA	17	ADDRESS	132 SUWANNEE LN
APPRAISER NAME	DZC	BRANCH OFFICE	TITUSVILLE

IMPROVEMENTS SKETCH

Please check 3x22 area on right side of gar
 Could not tell from plans if gar or la
 (stair area)

There was no 2nd floor plan for this, only a 'sorta' truss plan.
 Plans say upstairs is attic and so does bldg. official
 with a square footage of 522 and a balcony of 170 S.F.
 Dimensions are most likely wrong! Check if possible.
 Was basically a guess!!

ps.....sorry guys!)

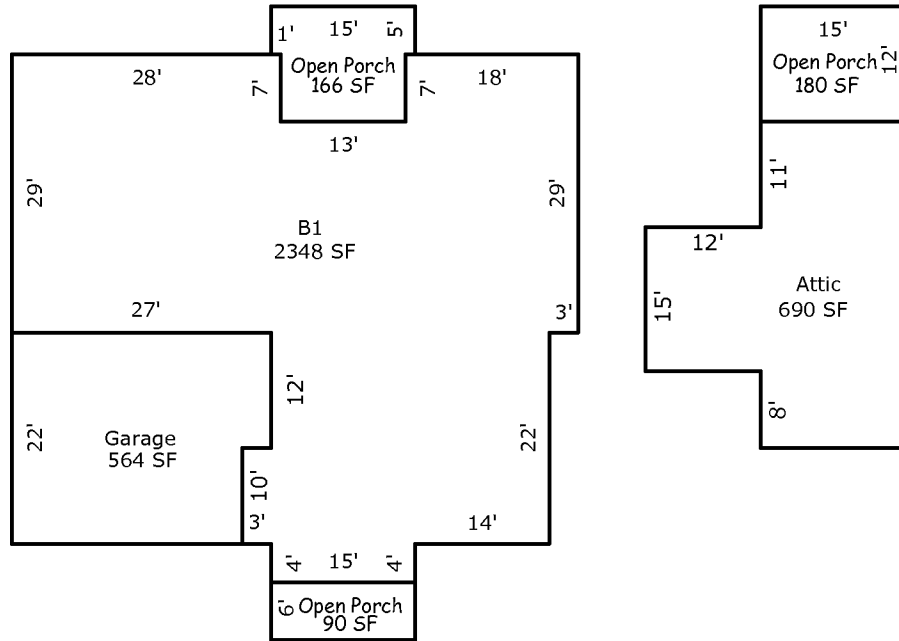

3 bed/3 bath

Scale: 1" = 12'

AREA CALCULATIONS

AREA CALCULATIONS SUMMARY

Code	Description	Factor	Net Size	Perimeter	Net Totals
B1	B1	1.00	2348	248	2348
GA	Garage	1.00	564	98	564
OP	Open Porch	1.00	90	42	
	Open Porch	1.00	166	54	
	Open Porch	1.00	180	54	436
AT	Attic	1.00	690	122	690

Comment Table 1

--	--

Comment Table 2

Comment Table 3

--	--