

SKETCH/AREA TABLE ADDENDUM

DATE 16 JULY, 2011

RE # 2440149

SUBJECT	PARCEL ID 24 373402 A 27	CITY COCOA BEACH	COUNTY BREVARD	STATE FL	ZIP 32931
	PERMIT # 1000001872	ADDRESS 313 ANGELO LN.			
	MARKET AREA 16	BRANCH OFFICE TITUSVILLE			
	APPRaiser NAME WHS				

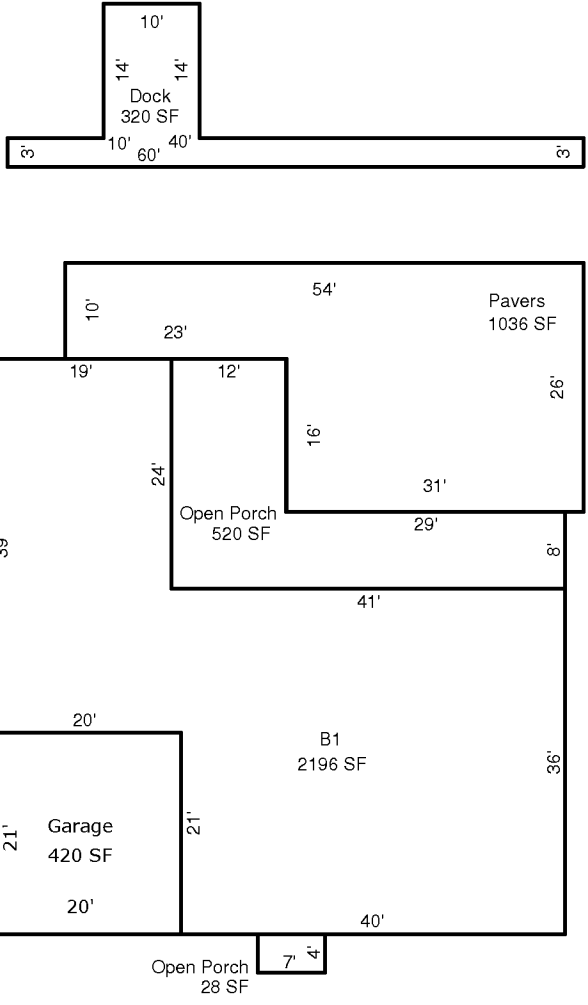

Scale: 1" = 12'

AREA CALCULATIONS	AREA CALCULATIONS SUMMARY					
	Code	Description	Factor	Net Size	Perimeter	Net Totals
	B1	B1	1.00	2196	240	2196
	GA	Garage	1.00	420	82	420
	OP	Open Porch	1.00	520	130	548
	Open Porch	1.00	28	22	320	
DOCK	Dock	1.00	320	154	320	
PAVST	Pavers	1.00	1036	160	1036	

Comment Table 1	
Comment Table 2	Comment Table 3