

SKETCH/AREA TABLE ADDENDUM

File No 2440069

Property Address 243734IA 3

City COCOA BEACH

County Brevard

State FL

Zip 32931

Owner

Client 17

Client Address 323 CARMINE DR

Appraiser Name M17 draw / M19 field

Inspection Date MI

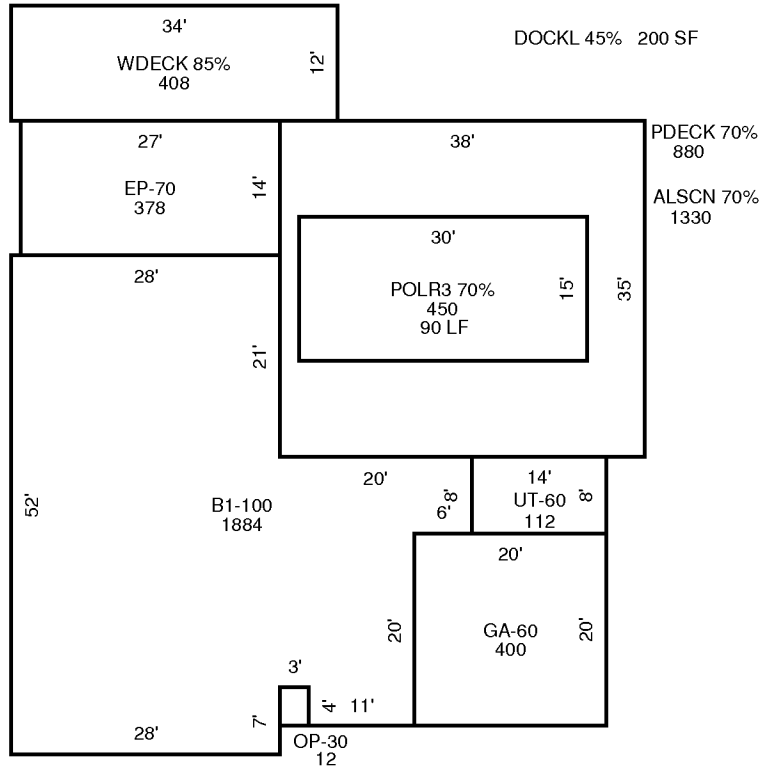

AREA CALCULATIONS SUMMARY

Code	Description	Factor	Net Size	Perimeter	Net Totals
B1	B1-100	1.00	1884	208	1884
GA7	GA-60	1.00	400	80	400
OP4	OP-30	1.00	12	14	12
EP4	EP-70	1.00	378	82	378
UT7	UT-60	1.00	112	44	112
ALSCN	ALSCN 70%	1.00	1330	146	1330
PDECK	PDECK 70%	1.00	880	146	880
POOL	POLR3 70%	1.00	450	90	450
WDECK	WDECK 85%	1.00	408	92	408

Comment Table 1

Comment Table 2

Comment Table 3