

SKETCH/AREA TABLE ADDENDUM

DATE 04.15.10

RE # 2440051

PARCEL ID 24-37-34-CJ-38-14

CITY COCOA BEACH

COUNTY BREVARD

STATE FL

ZIP 32931

PERMIT # RECHECK

MARKET AREA 17

ADDRESS 118 W GADSDEN LN

APPRAISER NAME JCA

BRANCH OFFICE MERRITT ISLAND

SUBJECT

IMPROVEMENTS SKETCH

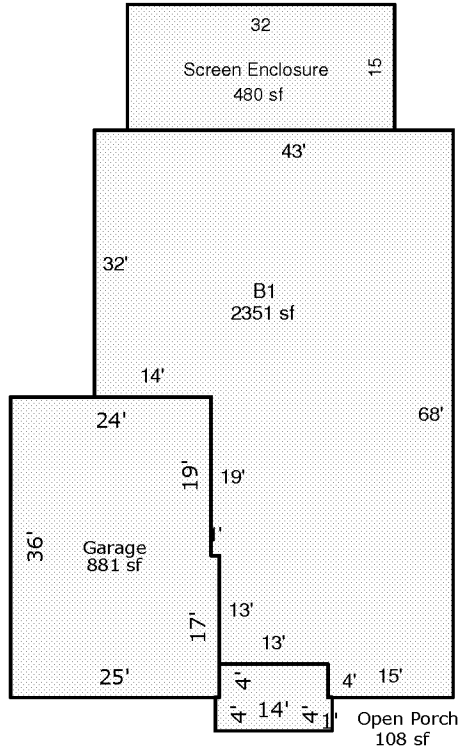

Scale: 1 = 23

AREA CALCULATIONS SUMMARY

| Code | Description | Factor | Net Size | Perimeter | Net Totals |
|-------|------------------|--------|----------|-----------|------------|
| B1 | B1 | 1.00 | 2351 | 222 | 2351 |
| GA | Garage | 1.00 | 881 | 122 | 881 |
| OP | Open Porch | 1.00 | 108 | 44 | 108 |
| SCREN | Screen Enclosure | 1.00 | 480 | 94 | 480 |

Comment Table 1

Comment Table 2

Comment Table 3

AREA CALCULATIONS