

# SKETCH/AREA TABLE ADDENDUM

DATE 06.09.10

RE # 2436657

SUBJECT

PARCEL ID	24 3726CI	24	2	COUNTY	BREVARD	STATE	FLORIDA	ZIP
CITY	COCOA BEACH			COUNTY	BREVARD	STATE	FLORIDA	ZIP
PERMIT #								
MARKET AREA	ADDRESS 147 PASCO LA E.							
APPRAISER NAME	JCA			BRANCH OFFICE	MERRITT ISLAND			

IMPROVEMENTS SKETCH

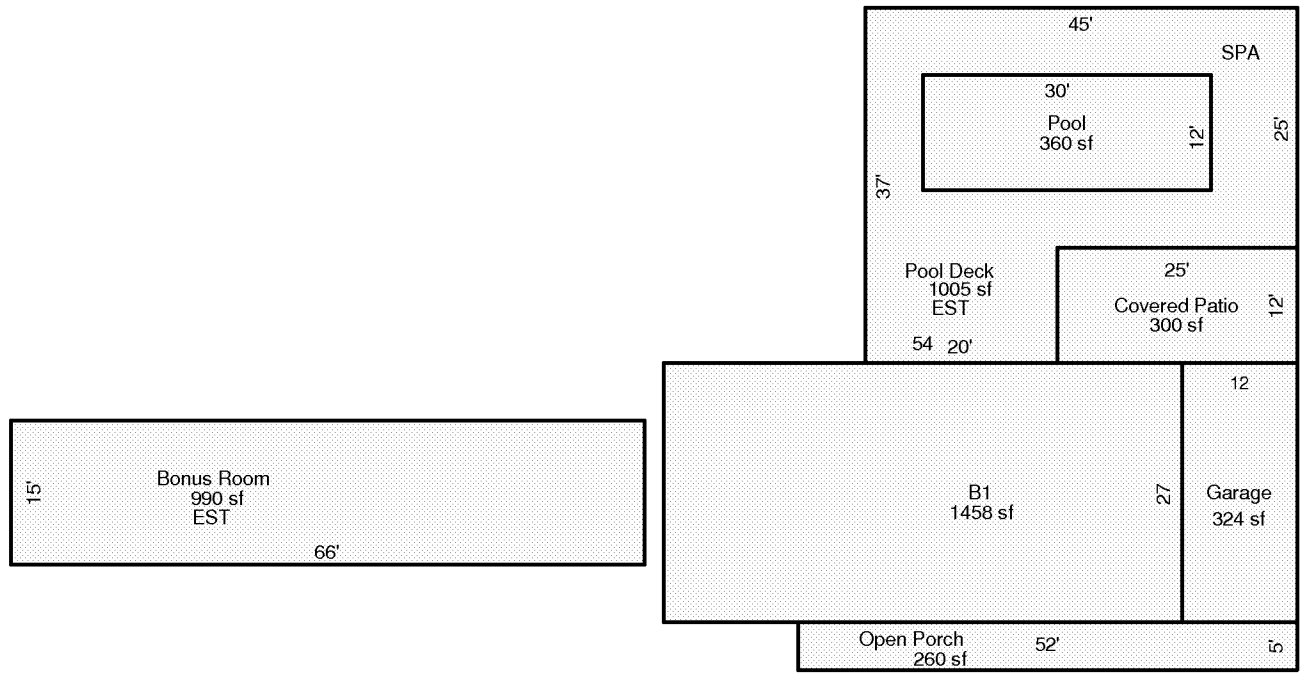

Scale: 1 = 20

AREA CALCULATIONS

### AREA CALCULATIONS SUMMARY

Code	Description	Factor	Net Size	Perimeter	Net Totals
B1	B1	1.00	1458	162	1458
GA	Garage	1.00	324	78	324
OP	Open Porch	1.00	260	114	260
BR	Bonus Room	1.00	990	162	990
CVPRT	Covered Patio	1.00	300	74	300
PDECK	Pool Deck	1.00	1005	164	1005
POOL	Pool	1.00	360	84	360

### Comment Table 1

--	--

### Comment Table 2

### Comment Table 3

--	--