

SKETCH/AREA TABLE ADDENDUM

File No 2431770

Property Address 24-37-19-01-2-7

City MERRITT ISLAND

County Brevard

State FL

Zip 32952

Owner

Client 16

Client Address 1655 WAVECREST ST

Appraiser Name Beau Sheridan

Inspection Date Merritt Island

DOCKL
8X20 SF

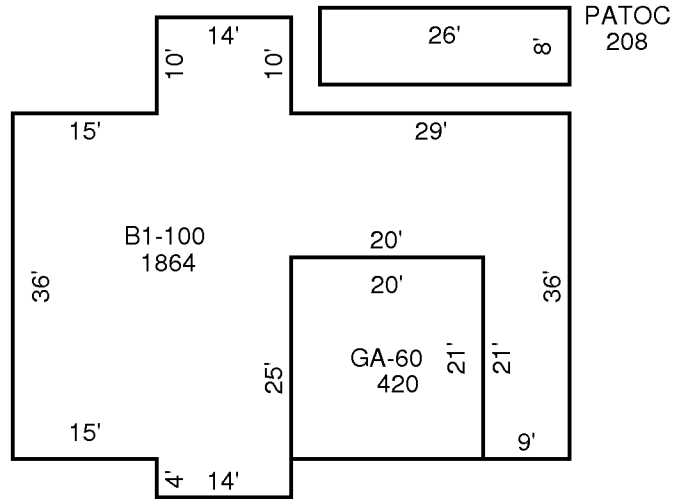

AREA CALCULATIONS SUMMARY

Code	Description	Factor	Net Size	Perimeter	Net Totals
B1	B1-100	1.00	1864	258	1864
GA7	GA-60	1.00	420	82	420
PT	PATOC	1.00	208	68	208

Comment Table 1

Comment Table 2

Comment Table 3