

SKETCH/AREA TABLE ADDENDUM

DATE 22 JAN. 2010

RE # 2430207

SUBJECT

| | | | |
|------------------------|--------------------------|----------|-----------|
| PARCEL ID 24 371455 80 | | | |
| CITY CAPE CANAVERAL | COUNTY BREVARD | STATE FL | ZIP 32920 |
| PERMIT # NONE | | | |
| MARKET AREA 17 | ADDRESS 8771 COCOA CT. | | |
| APPRAISER NAME WHS | BRANCH OFFICE TITUSVILLE | | |

IMPROVEMENTS SKETCH

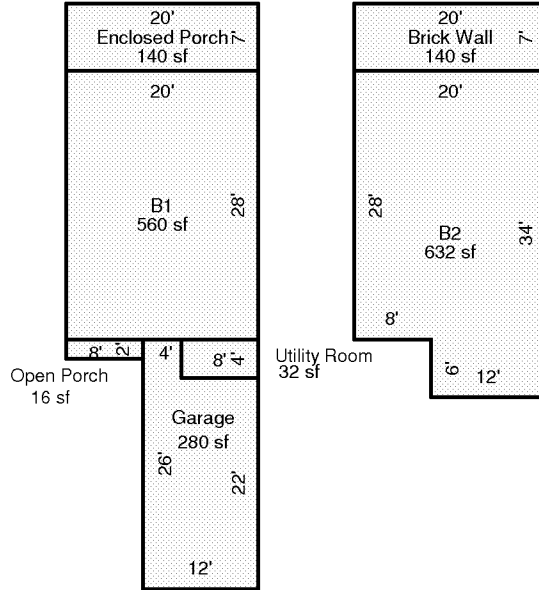

Scale: 1 = 20

AREA CALCULATIONS

AREA CALCULATIONS SUMMARY

| Code | Description | Factor | Net Size | Perimeter | Net Totals |
|-------|----------------|--------|----------|-----------|------------|
| B1 | B1 | 1.00 | 560 | 96 | 560 |
| B2 | B2 | 1.00 | 632 | 108 | 632 |
| GA | Garage | 1.00 | 280 | 76 | 280 |
| EP | Enclosed Porch | 1.00 | 140 | 54 | 140 |
| OP | Open Porch | 1.00 | 16 | 20 | 16 |
| UT | Utility Room | 1.00 | 32 | 24 | 32 |
| WALBR | Brick Wall | 1.00 | 140 | 54 | 140 |

Comment Table 1

| |
|--|
| |
|--|

Comment Table 2

Comment Table 3

| | |
|--|--|
| | |
|--|--|