

SKETCH/AREA TABLE ADDENDUM

File No 2429584

Property Address 24371402 38

City Cape Canaveral

County Brevard

State FL

Zip 32920

Owner

Client 17

Client Address 382 CORAL DR

Appraiser Name M09 DRAW / M14 FIELD

Inspection Date MI

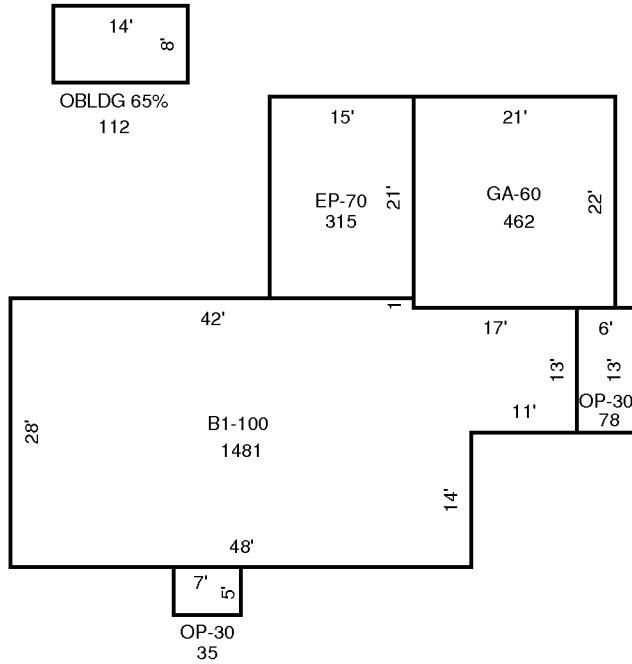

AREA CALCULATIONS SUMMARY

Code	Description	Factor	Net Size	Perimeter	Net Totals
B1	B1-100	1.00	1481	174	1481
GA7	GA-60	1.00	462	86	462
OP4	OP-30	1.00	78	38	
	OP-30	1.00	35	24	113
EP4	EP-70	1.00	315	72	315
OBLDG	OBLDG 65%	1.00	112	44	112

Comment Table 1

Comment Table 2

Comment Table 3