

# SKETCH/AREA TABLE ADDENDUM

Parcel No 6/1/09

File No 2428002

Property Address 24 36 36 00 518

City MERRITT ISLAND

County BREVARD

State FL

Zip 32952

Owner NONE

Client 52

Client Address 555 FORTENBERRY RD

Appraiser Name JXS

Inspection Date TITUSVILLE

SUBJECT

IMPROVEMENTS SKETCH

PDC # 1

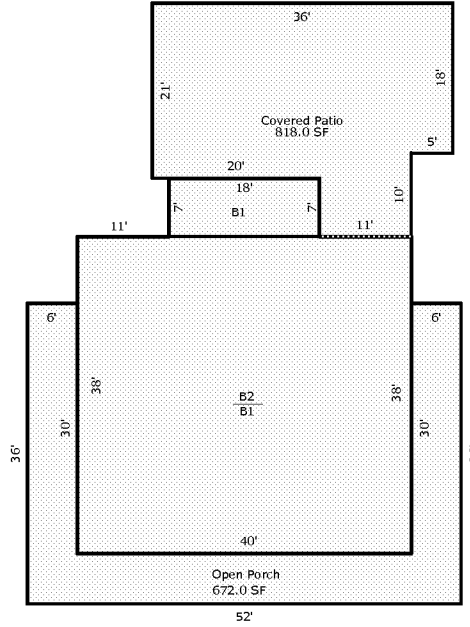

Scale: 1 = 23

## AREA CALCULATIONS SUMMARY

| Code  | Description   | Factor | Net Size | Perimeter | Net Totals |
|-------|---------------|--------|----------|-----------|------------|
| B1    | B1            | 1.00   | 1646.0   | 170.0     | 1646.0     |
| B2    | B2            | 1.00   | 1520.0   | 156.0     | 1520.0     |
| OP    | Open Porch    | 1.00   | 672.0    | 236.0     | 672.0      |
| CVPRT | Covered Patio | 1.00   | 818.0    | 128.0     | 818.0      |

Comment Table 1

Comment Table 2

Comment Table 3

AREA CALCULATIONS

# SKETCH/AREA TABLE ADDENDUM

Parcel No 6/1/09

File No 2428002

Property Address 24 36 36 00 518

City MERRITT ISLAND

County BREVARD

State FL

Zip 32952

Owner NONE

Client 52

Client Address 555 FORTENBERRY RD

Appraiser Name JXS

Inspection Date TITUSVILLE

SUBJECT

IMPROVEMENTS SKETCH

PDC # 2

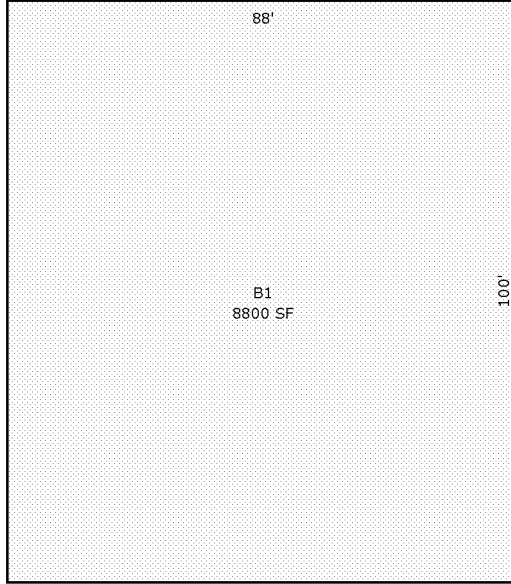

Scale: 1 = 33

AREA CALCULATIONS

### AREA CALCULATIONS SUMMARY

| Code | Description | Factor | Net Size | Perimeter | Net Totals |
|------|-------------|--------|----------|-----------|------------|
| B1   | B1          | 1.00   | 8800.0   | 376.0     | 8800.0     |

### Comment Table 1

|  |  |
|--|--|
|  |  |
|--|--|

### Comment Table 2

### Comment Table 3

|  |  |
|--|--|
|  |  |
|--|--|