

SKETCH/AREA TABLE ADDENDUM

DATE 21 JAN. 2010

RE # 2425880

SUBJECT

PARCEL ID 24 363331 D 16			
CITY COCOA	COUNTY BREVARD	STATE FL	ZIP 32922
PERMIT # 0800005354			
MARKET AREA 07	ADDRESS 361 STONE ST.		
APPRAISER NAME WHS	BRANCH OFFICE TITUSVILLE		

IMPROVEMENTS SKETCH

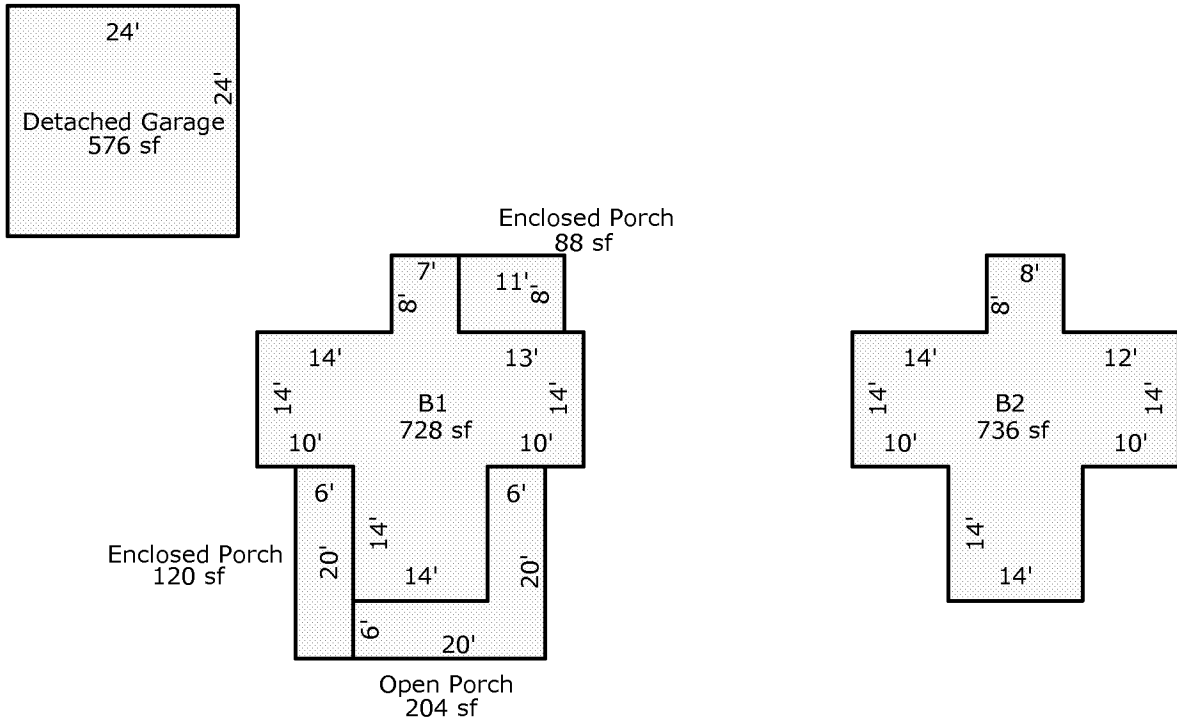

Scale: 1 = 20

AREA CALCULATIONS

AREA CALCULATIONS SUMMARY

Code	Description	Factor	Net Size	Perimeter	Net Totals
B1	B1	1.00	728	140	728
B2	B2	1.00	736	140	736
EP	Enclosed Porch	1.00	120	52	
	Enclosed Porch	1.00	88	38	208
OP	Open Porch	1.00	204	80	204
GRGD	Detached Garage	1.00	576	96	576

Comment Table 1

--	--

Comment Table 2

Comment Table 3

--	--