

# SKETCH/AREA TABLE ADDENDUM

DATE 9 JUNE, 2010

RE # 2425292

SUBJECT

PARCEL ID 24 3633CC 12 5

CITY COCOA

COUNTY BREVARD

STATE FL

ZIP 32922

PERMIT # NONE

MARKET AREA 07

ADDRESS 436 SATSUMA ST.

APPRAISER NAME WHS

BRANCH OFFICE TITUSVILLE

IMPROVEMENTS SKETCH

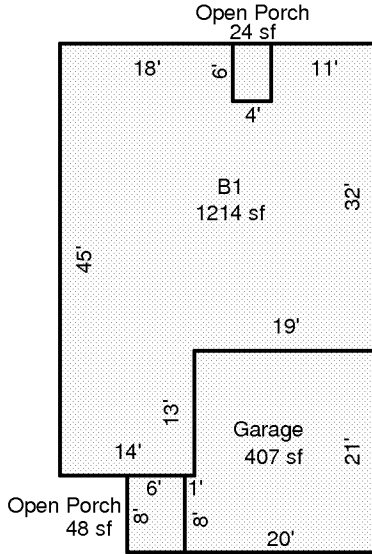

Scale: 1 = 20

AREA CALCULATIONS

### AREA CALCULATIONS SUMMARY

Code	Description	Factor	Net Size	Perimeter	Net Totals
B1	B1	1.00	1214	168	1214
GA	Garage	1.00	407	82	407
OP	Open Porch	1.00	48	28	
	Open Porch	1.00	24	20	72

#### Comment Table 1

--

#### Comment Table 2

#### Comment Table 3

--	--