

# SKETCH/AREA TABLE ADDENDUM

DATE 4 MAR. 2010

RE # 2419325

SUBJECT	PARCEL ID 24 3626IS 4 5	CITY MERRITT ISLAND	COUNTY BREVARD	STATE FL	ZIP 32953
	PERMIT # NONE				
	MARKET AREA 16	ADDRESS 1005 CASA BLANCA DR.			
	APPRAISER NAME WHS	BRANCH OFFICE TITUSVILLE			

IMPROVEMENTS SKETCH

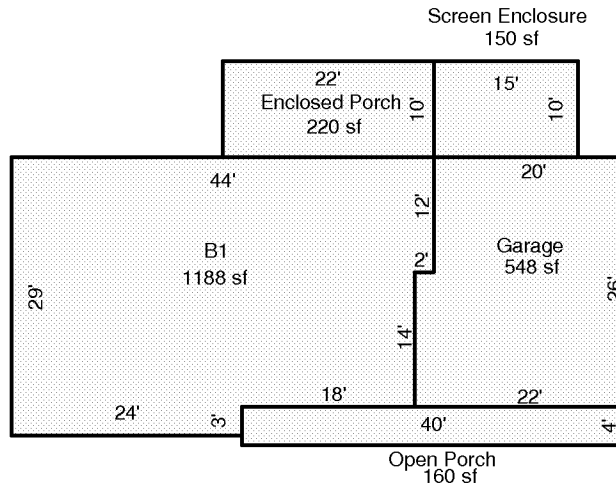

Scale: 1 = 20

AREA CALCULATIONS

### AREA CALCULATIONS SUMMARY

Code	Description	Factor	Net Size	Perimeter	Net Totals
B1	B1	1.00	1188	146	1188
GA	Garage	1.00	548	96	548
EP	Enclosed Porch	1.00	220	64	220
OP	Open Porch	1.00	160	88	160
SCREEN	Screen Enclosure	1.00	150	50	150

#### Comment Table 1

--

#### Comment Table 2

#### Comment Table 3

--	--