

SKETCH/AREA TABLE ADDENDUM

DATE 4 JUNE, 2010

RE # 2416721

SUBJECT	PARCEL ID 24 362055 2 8
CITY COCOA	COUNTY BREVARD STATE FL ZIP 32926
PERMIT # NONE	
MARKET AREA 07	ADDRESS 1450 CLEARLAKE CT.
APPRAISER NAME WHS	BRANCH OFFICE MERRITT ISLAND

IMPROVEMENTS SKETCH

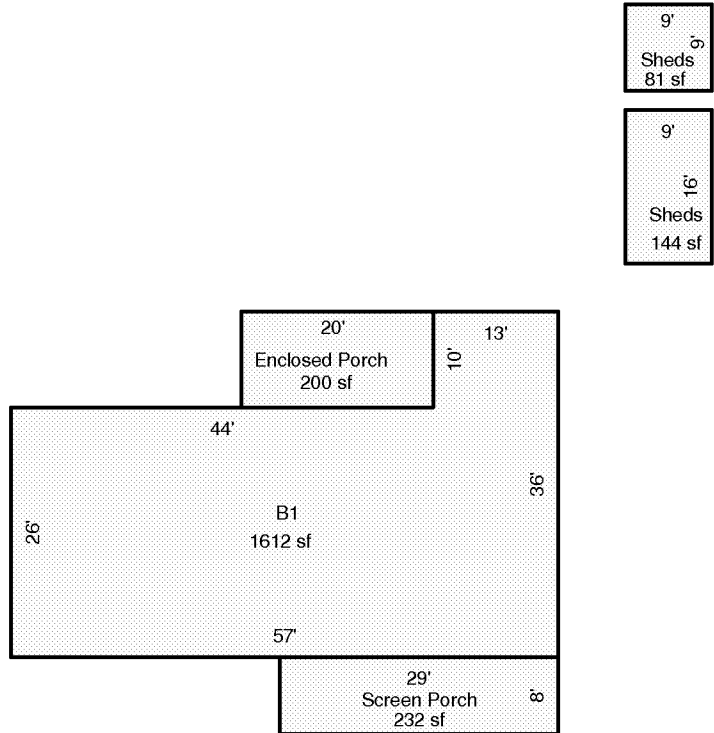

Scale: 1 = 20

AREA CALCULATIONS

AREA CALCULATIONS SUMMARY

Code	Description	Factor	Net Size	Perimeter	Net Totals
B1	B1	1.00	1612	186	1612
EP	Enclosed Porch	1.00	200	60	200
SP	Screen Porch	1.00	232	74	232
SHED	Sheds	1.00	81	36	232
	Sheds	1.00	144	50	225

Comment Table 1

--	--

Comment Table 2

Comment Table 3

--	--