

# SKETCH/AREA TABLE ADDENDUM

Parcel No 21 JUNE, 2011

File No 2413977

Property Address 24 361753 19 7

City COCOA

County BREVARD

State FL

Zip 32922

Owner 1100000140

Client 07

Client Address 2211 COCOA BLVD. N.

Appraiser Name WHS

Inspection Date TITUSVILLE

SUBJECT

## DEMOED AS OF 21 JUNE, 2011

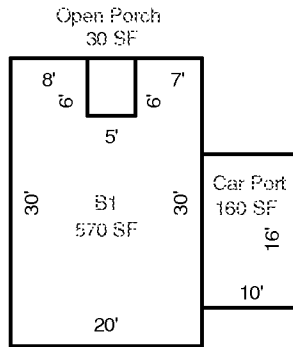

IMPROVEMENTS SKETCH

Scale: 1" = 12'

### AREA CALCULATIONS SUMMARY

Code	Description	Factor	Net Size	Perimeter	Net Totals
B1	B1	1.00	570	112	570
OP	Open Porch	1.00	30	22	30
CP	Car Port	1.00	160	52	160

Comment Table 1

Comment Table 2

Comment Table 3

AREA CALCULATIONS