

SKETCH/AREA TABLE ADDENDUM

File No 2413645

Property Address 24-36-17-03-A-13

City COCOA

County Brevard

State FL

Zip

Owner

Client Client Address 310 FOREST HILL DR

Appraiser Name RDK

Inspection Date Merritt Island

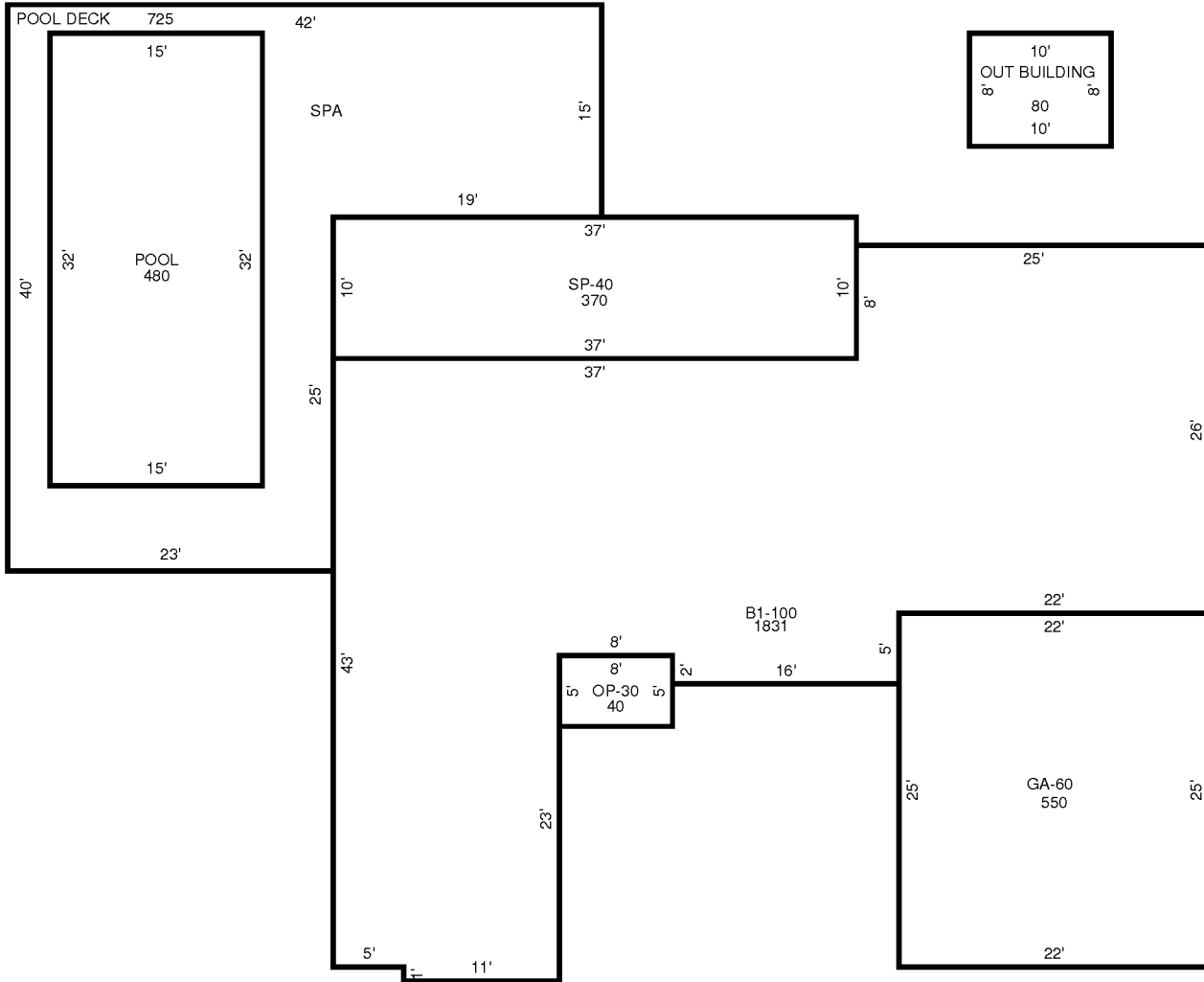

AREA CALCULATIONS SUMMARY

Code	Description	Factor	Net Size	Perimeter	Net Totals
B1	B1-100	1.00	1831	232	1831
GA7	GA-60	1.00	550	94	550
OP4	OP-30	1.00	40	26	40
SP4	SP-40	1.00	370	94	370
OBLDG	OUT BUILDING	1.00	80	36	80
PDECK	POOL DECK	1.00	725	164	725
POOL	POOL	1.00	480	94	480

Comment Table 1

Comment Table 2

Comment Table 3
