

SKETCH/AREA TABLE ADDENDUM

RE # 2411274

SUBJECT	PARCEL ID 2411274	CITY COCOA	COUNTY BREVARD	STATE FL	ZIP 32926
	PERMIT # 10-28-11				
	MARKET AREA 06	ADDRESS 125 CITY POINT RD			
	APPRAISER NAME DZC				

IMPROVEMENTS SKETCH

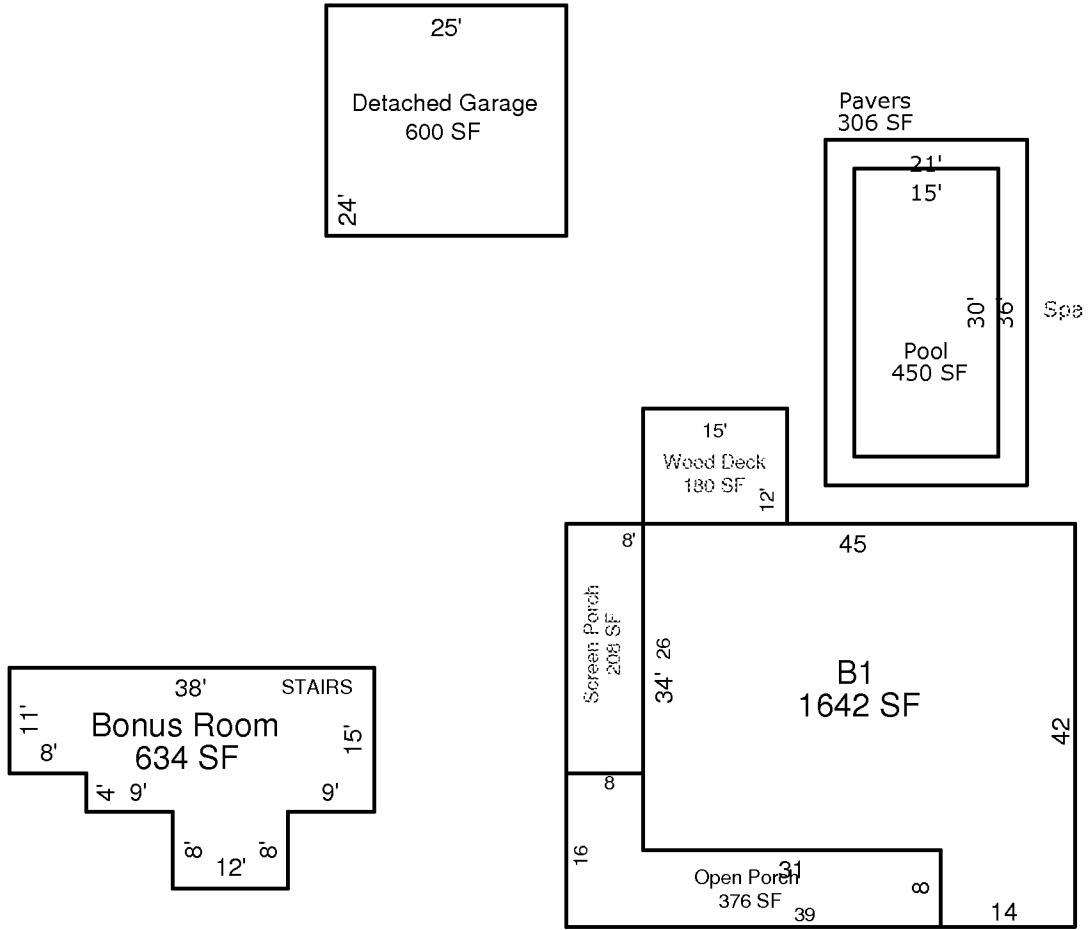

Scale: 1" = 12'

AREA CALCULATIONS

AREA CALCULATIONS SUMMARY

Code	Description	Factor	Net Size	Perimeter	Net Totals
B1	B1	1.00	1642	174	1642
OP	Open Porch	1.00	376	110	376
SP	Screen Porch	1.00	208	68	208
BR	Bonus Room	1.00	634	122	634
GRGD	Detached Garage	1.00	600	98	600
PAVST	Pavers	1.00	306	114	306
POOL	Pool	1.00	450	90	450
WDECK	Wood Deck	1.00	180	54	180
