

# SKETCH/AREA TABLE ADDENDUM

Date 9/30/09

RE # 2411105

Parcel ID 24-36-07-02-<sup>a</sup>-16

City COCOA

County BREVARD

State FL

Zip 32926

Permit # RECHECK

Market Area 06

Address 503 LOUIS DR

Appraiser Name JEC

Branch Office VIERA

SUBJECT

IMPROVEMENTS SKETCH

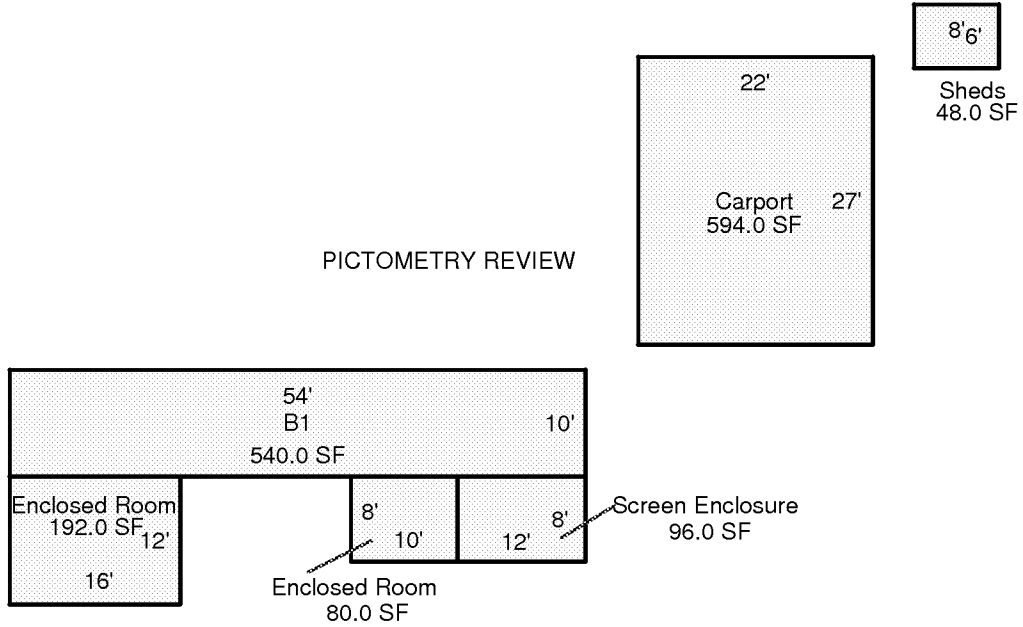

Scale: 1 = 18

AREA CALCULATIONS

### AREA CALCULATIONS SUMMARY

Code	Description	Factor	Net Size	Perimeter	Net Totals
B1	B1	1.00	540.0	128.0	540.0
CRPRT	Carport	1.00	594.0	98.0	594.0
ENCLR	Enclosed Room	1.00	192.0	56.0	
	Enclosed Room	1.00	80.0	36.0	272.0
SCREN	Screen Enclosure	1.00	96.0	40.0	96.0
SHED	Sheds	1.00	48.0	28.0	48.0

#### Comment Table 1

--

#### Comment Table 2

#### Comment Table 3

--	--