

# SKETCH/AREA TABLE ADDENDUM

Date 9/30/09

RE # 2411099

Parcel ID 24-36-07-02-<sup>a</sup>-10

City COCOA

County BREVARD

State FL

Zip 32926

Permit # RECHECK

Market Area 06

Address 515 LOUIS DR

Appraiser Name JEC

Branch Office VIERA

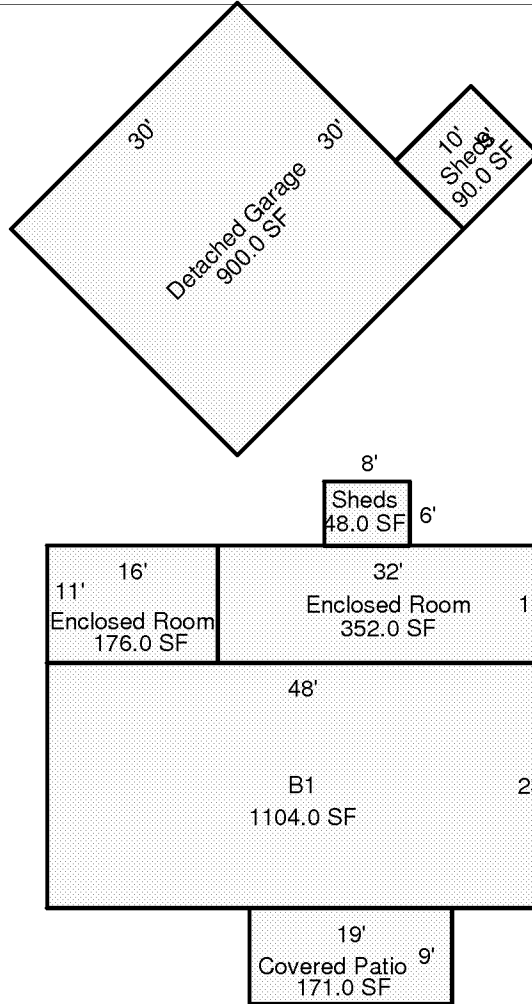

Scale: 1 = 18

## AREA CALCULATIONS SUMMARY

Code	Description	Factor	Net Size	Perimeter	Net Totals
B1	B1	1.00	1104.0	142.0	1104.0
CVPRT	Covered Patio	1.00	171.0	56.0	171.0
ENCLR	Enclosed Room	1.00	352.0	86.0	
	Enclosed Room	1.00	176.0	54.0	528.0
GRGD	Detached Garage	1.00	900.0	120.0	900.0
SHED	Sheds	1.00	90.0	38.0	
	Sheds	1.00	48.0	28.0	138.0

### Comment Table 1

--

### Comment Table 2

### Comment Table 3

--	--

AREA CALCULATIONS

IMPROVEMENTS SKETCH

SUBJECT