

SKETCH/AREA TABLE ADDENDUM

Date 9/30/09

RE # 2411092

SUBJECT	Parcel ID 24-36-07-02-3			
	City COCOA	County BREVARD	State FL	Zip 32926
	Permit # RECHECK			
	Market Area 06	Address 506 LOUIS DR		
	Appraiser Name JEC	Branch Office VIERA		

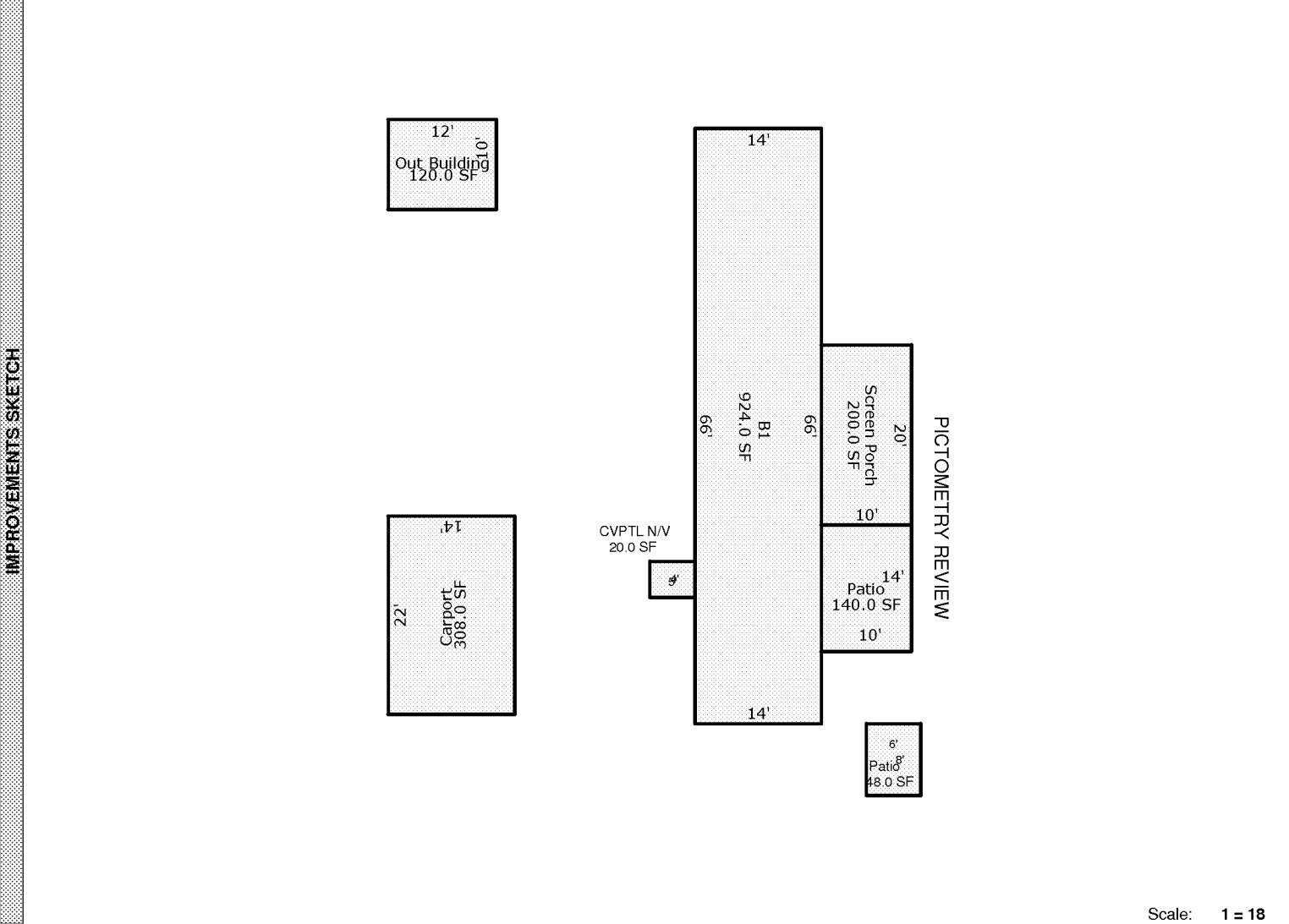

Scale: 1 = 18

AREA CALCULATIONS	AREA CALCULATIONS SUMMARY						Comment Table 1	
	Code	Description	Factor	Net Size	Perimeter	Net Totals		
	B1	B1	1.00	924.0	160.0	924.0		
	SP	Screen Porch	1.00	200.0	60.0	200.0		
	CRPRT	Carport	1.00	308.0	72.0	308.0		
	OBLD	Out Building	1.00	120.0	44.0	120.0		
	PATIO	Patio	1.00	140.0	48.0	48.0		
		Patio	1.00	48.0	28.0	188.0		
							Comment Table 2	Comment Table 3