

SKETCH/AREA TABLE ADDENDUM

Parcel No 4/16/07

File No 2409774

Property Address 24-35-36-50-14

City COCOA

County BREVARD

State FL

Zip 32926

Owner

Client Client Address 3782 CATALINA DR.

Appraiser Name JEC

Inspection Date PALM BAY

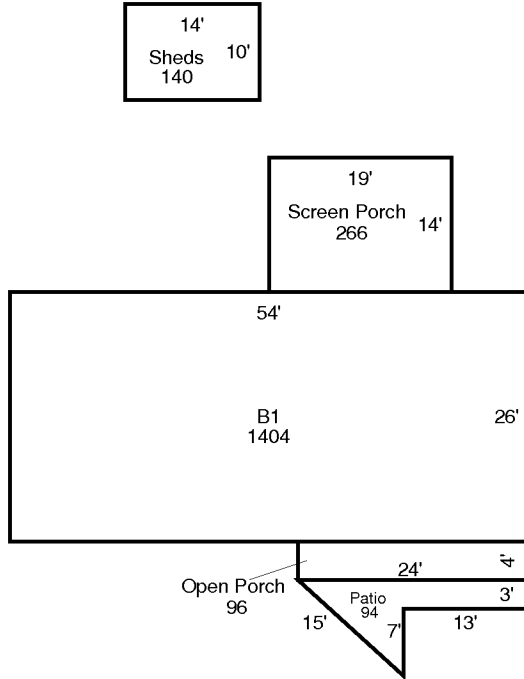

AREA CALCULATIONS SUMMARY

Code	Description	Factor	Net Size	Perimeter	Net Totals
B1	B1	1.00	1404	160	1404
OP	Open Porch	1.00	96	56	96
PT	Patio	1.00	94	62	94
SP	Screen Porch	1.00	266	66	266
SHED	Sheds	1.00	140	48	140

Comment Table 1

--	--

Comment Table 2

Comment Table 3

--	--