

SKETCH/AREA TABLE ADDENDUM

DATE 12/1/09

RE # 2405095

PARCEL ID 24-35-14-00-39

CITY COCOA

COUNTY BREVARD

STATE FL

ZIP 32926

PERMIT # RECHECK

MARKET AREA 06

ADDRESS 2344 ARMADILLO CT

APPRAISER NAME JEC

BRANCH OFFICE VIERA

SUBJECT

IMPROVEMENTS SKETCH

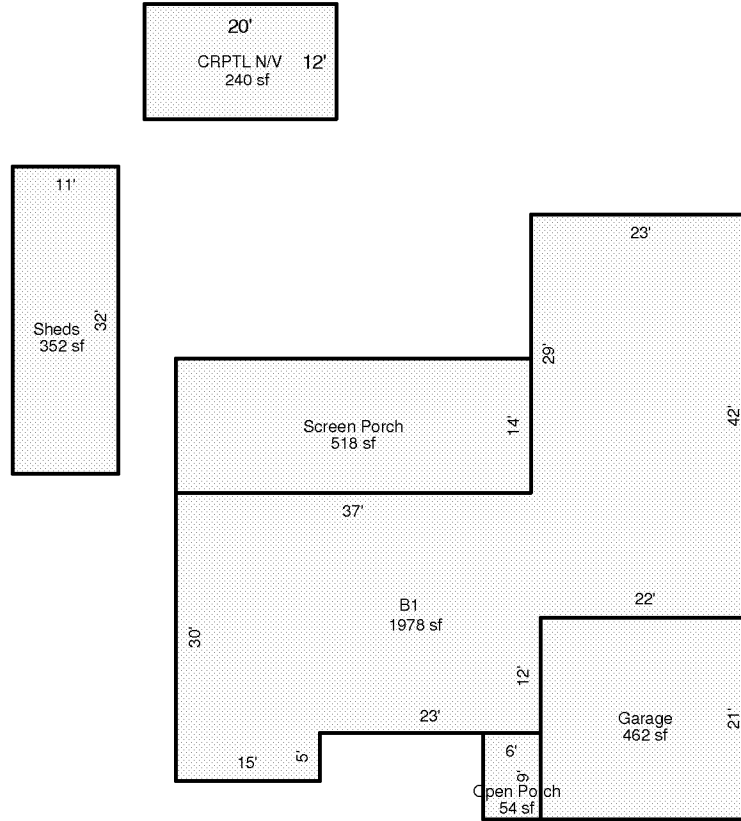

Scale: 1 = 20

AREA CALCULATIONS

AREA CALCULATIONS SUMMARY

Code	Description	Factor	Net Size	Perimeter	Net Totals
B1	B1	1.00	1978	238	1978
GA	Garage	1.00	462	86	462
OP	Open Porch	1.00	54	30	54
SP	Screen Porch	1.00	518	102	518
SHED	Sheds	1.00	352	86	352

Comment Table 1

--	--

Comment Table 2

Comment Table 3

--	--