

SKETCH/AREA TABLE ADDENDUM

Parcel No 12/9/08

File No 2322625

Property Address 233621JX180-14.10

City COCOA

County BREVARD

State FL

Zip 32927

Owner NA

Client 04

Client Address 6075 CORSICA BLVD

Appraiser Name THL

Inspection Date VIERA

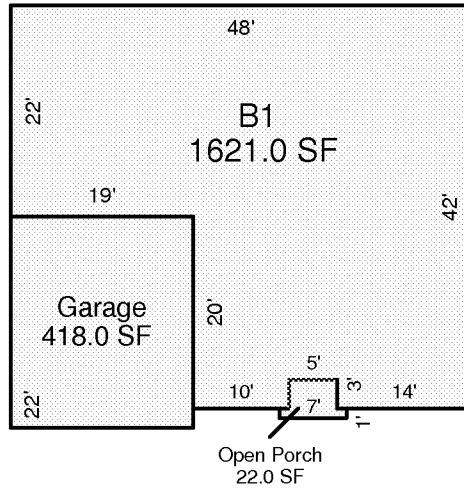

Scale: 1 = 20

AREA CALCULATIONS SUMMARY

Code	Description	Factor	Net Size	Perimeter	Net Totals
B1	B1	1.00	1621.0	186.0	1621.0
GA	Garage	1.00	418.0	82.0	418.0
OP	Open Porch	1.00	22.0	22.0	22.0

Comment Table 1

Comment Table 2

Comment Table 3

AREA CALCULATIONS

SUBJECT

IMPROVEMENTS SKETCH