

SKETCH/AREA TABLE ADDENDUM

Parcel No 5 NOV. 2009

File No 2322623

Property Address 23 3521JX 180 14.08

City COCOA County BREVARD State FL Zip 32927

Owner 09BC03416

Client 04 Client Address 6135 CORSICA BLVD.

Appraiser Name WHS Inspection Date TITUSVILLE

SHED NV

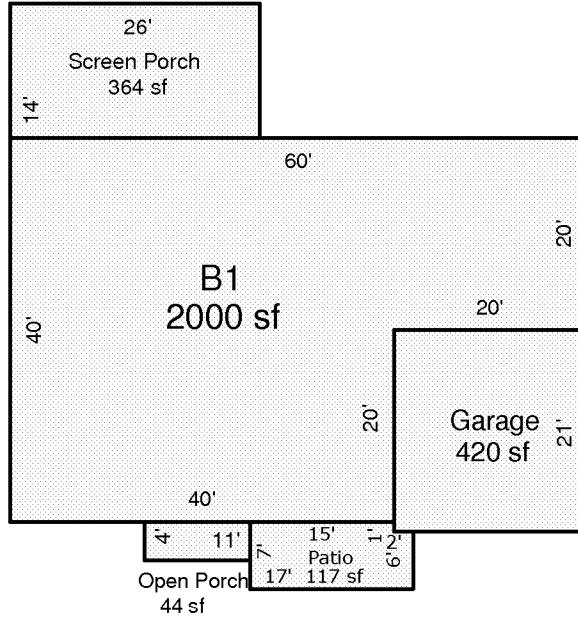

Scale: 1 = 20

AREA CALCULATIONS SUMMARY

Code	Description	Factor	Net Size	Perimeter	Net Totals
B1	B1	1.00	2000	200	2000
GA	Garage	1.00	420	82	420
OP	Open Porch	1.00	44	30	44
SP	Screen Porch	1.00	364	80	364
PATIO	Patio	1.00	117	48	117

Comment Table 1

--	--

Comment Table 2

Comment Table 3

--	--

AREA CALCULATIONS

SUBJECT

IMPROVEMENTS SKETCH