

SKETCH/AREA TABLE ADDENDUM

DATE 07.16.10

RE # 2320435

PARCEL ID 23 351501 C 21

CITY COCOA

COUNTY BREVARD

STATE FL

ZIP 032927

PERMIT # 0

MARKET AREA 04

ADDRESS 7463 BUMELIA DR

APPRAISER NAME JCA

BRANCH OFFICE MERRITT ISLAND

SUBJECT

IMPROVEMENTS SKETCH

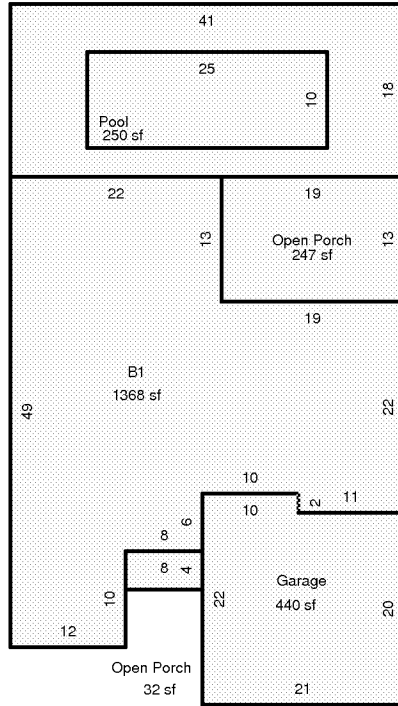

All Screen
738 sf
Pool Deck
488 sf

Scale: 1 = 20

AREA CALCULATIONS

AREA CALCULATIONS SUMMARY

| Code | Description | Factor | Net Size | Perimeter | Net Totals |
|-------|-------------|--------|----------|-----------|------------|
| B1 | B1 | 1.00 | 1368 | 184 | 1368 |
| GA | Garage | 1.00 | 440 | 86 | 440 |
| OP | Open Porch | 1.00 | 32 | 24 | |
| | Open Porch | 1.00 | 247 | 64 | 279 |
| ALSCN | All Screen | 1.00 | 738 | 118 | 738 |
| PDECK | Pool Deck | 1.00 | 488 | 118 | 488 |
| POOL | Pool | 1.00 | 250 | 70 | 250 |

Comment Table 1

Comment Table 2

Comment Table 3