

SKETCH/AREA TABLE ADDENDUM

Parcel No 10/21/09

File No 2320392

Property Address 23-35-15-01-B-13

City COCOA

County BREVARD

State FL

Zip 32927

Owner RECHECK

Client 04

Client Address 7302 BUMELIA DR

Appraiser Name JEC

Inspection Date VIERA

SUBJECT

IMPROVEMENTS SKETCH

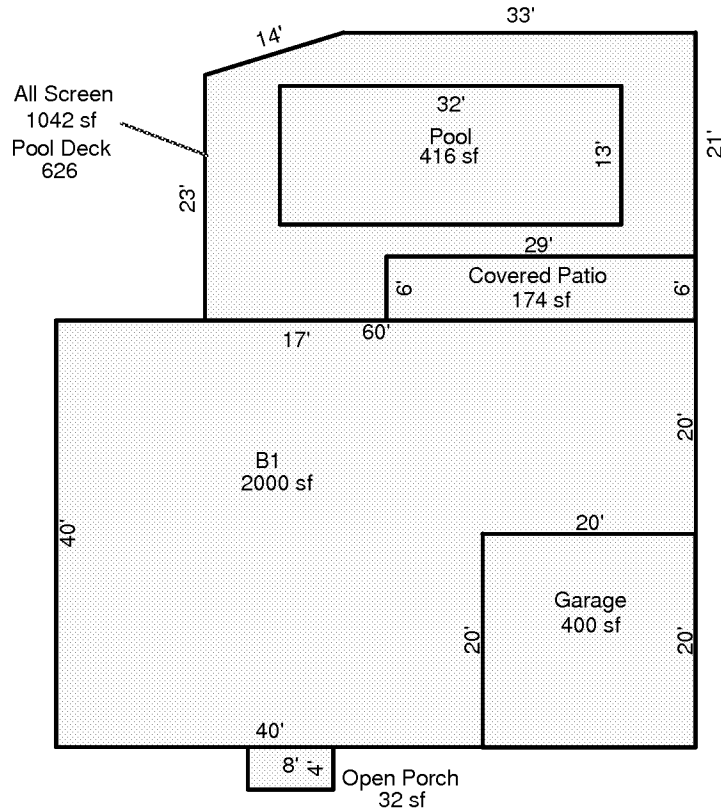

Scale: 1 = 18

AREA CALCULATIONS

AREA CALCULATIONS SUMMARY

Code	Description	Factor	Net Size	Perimeter	Net Totals
B1	B1	1.00	2000	200	2000
GA	Garage	1.00	400	80	400
OP	Open Porch	1.00	32	24	32
ALSCN	All Screen	1.00	1042	143	1042
CVPRT	Covered Patio	1.00	174	70	174
PDECK	Pool Deck	1.00	626	143	626
POOL	Pool	1.00	416	90	416

Comment Table 1

--	--

Comment Table 2

Comment Table 3

--	--