

# SKETCH/AREA TABLE ADDENDUM

DATE 09/30/2010

RE # 2318019

SUBJECT

|                |                 |               |                   |
|----------------|-----------------|---------------|-------------------|
| PARCEL ID      | 23-36-31-25-7-6 |               |                   |
| CITY           | COCOA           | COUNTY        | BREVARD           |
|                |                 | STATE         | FL                |
| PERMIT #       | n/a             |               |                   |
| MARKET AREA    | 6               | ADDRESS       | 7004 EVERGREEN DR |
| APPRAISER NAME | JTC             | BRANCH OFFICE | VIERA             |

IMPROVEMENTS SKETCH

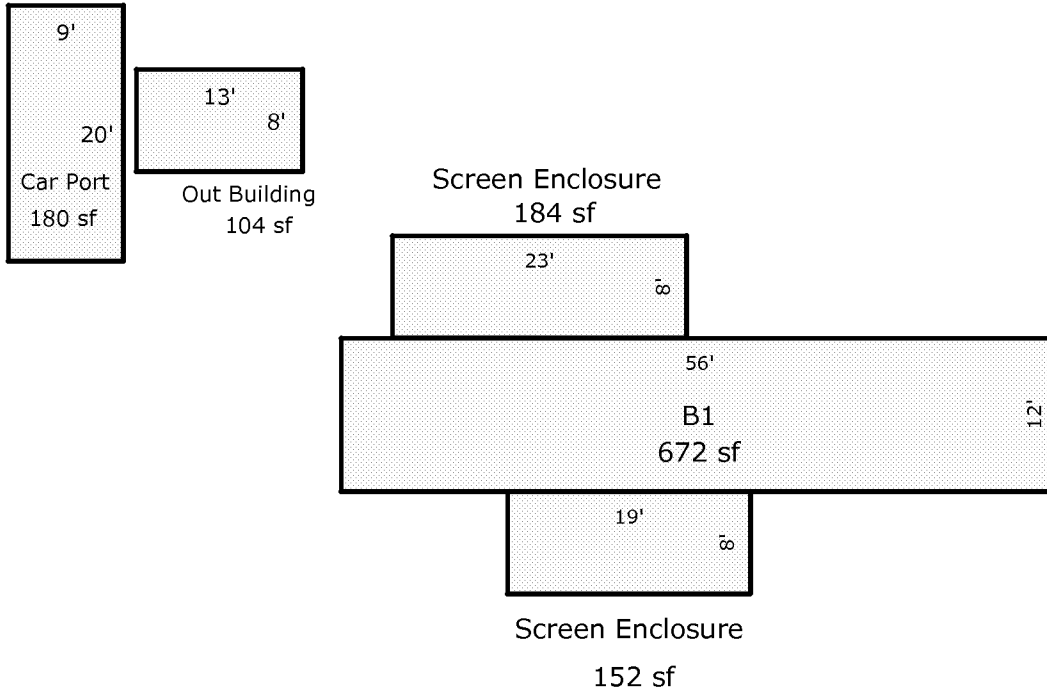

Scale: 1 = 15

AREA CALCULATIONS

### AREA CALCULATIONS SUMMARY

| Code   | Description      | Factor | Net Size | Perimeter | Net Totals |
|--------|------------------|--------|----------|-----------|------------|
| B1     | B1               | 1.00   | 672      | 136       | 672        |
| CP     | Car Port         | 1.00   | 180      | 58        | 180        |
| OBLD   | Out Building     | 1.00   | 104      | 42        | 104        |
| SCREEN | Screen Enclosure | 1.00   | 152      | 54        | 336        |
|        | Screen Enclosure | 1.00   | 184      | 62        |            |

UPDATED / CONVERTED TO APEX (NFC)  
\*NO ON SITE MEASUREMENTS CHECKED.