

SKETCH/AREA TABLE ADDENDUM

Date 9-22-09

RE # 2318011

SUBJECT

Parcel ID			
City COCOA	County BREVARD	State FL	Zip
Permit #			
Market Area		Address 7009 Evergreen Dr.	
Appraiser Name DZC		Branch Office TITUSVILLE	

IMPROVEMENTS SKETCH

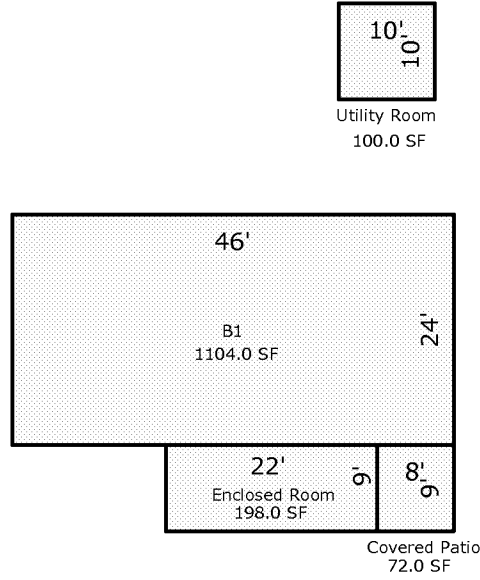

Scale: 1 = 20

AREA CALCULATIONS

AREA CALCULATIONS SUMMARY

Code	Description	Factor	Net Size	Perimeter	Net Totals
B1	B1	1.00	1104.0	140.0	1104.0
UT	Utility Room	1.00	100.0	40.0	100.0
CVPRT	Covered Patio	1.00	72.0	34.0	72.0
ENCLR	Enclosed Room	1.00	198.0	62.0	198.0

Comment Table 1

Comment Table 1	
-----------------	--

Comment Table 2

Comment Table 3

Comment Table 2	Comment Table 3
-----------------	-----------------