

SKETCH/AREA TABLE ADDENDUM

DATE 03/25/2010

RE # 2314948

SUBJECT

PARCEL ID 23-35-36-25-6-3			
CITY COCOA	COUNTY BREVARD	STATE FL	ZIP 32926
PERMIT # OT0208258			
MARKET AREA 061000	ADDRESS 4125 HESS AVENUE		
APPRAISER NAME JTC	BRANCH OFFICE TITUSVILLE		

IMPROVEMENTS SKETCH

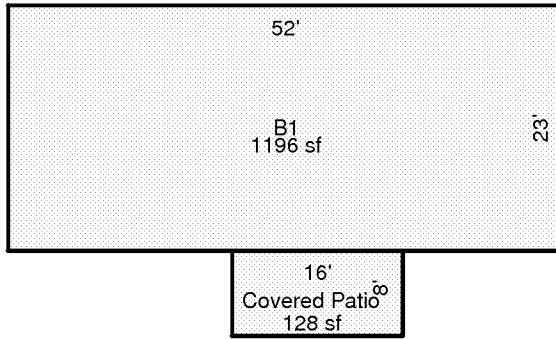
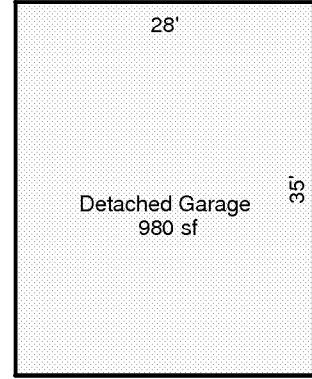
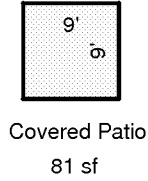

Scale: 1 = 18

AREA CALCULATIONS

AREA CALCULATIONS SUMMARY

Code	Description	Factor	Net Size	Perimeter	Net Totals
B1	B1	1.00	1196	150	1196
CVPRT	Covered Patio	1.00	128	48	
	Covered Patio	1.00	81	36	209
GRGD	Detached Garage	1.00	980	126	980

Comment Table 1

Comment Table 1	
-----------------	--

Comment Table 2

Comment Table 3

Comment Table 2	Comment Table 3
-----------------	-----------------