

SKETCH/AREA TABLE ADDENDUM

DATE 7-9-10

RE # 2312569

SUBJECT

PARCEL ID 23-35-28-JN-174-24

CITY COCOA

COUNTY Brevard

STATE FL

ZIP 32927

PERMIT #

MARKET AREA

ADDRESS 6255 CHAPMAN ST

APPRAISER NAME DZC

BRANCH OFFICE TITUSVILLE

IMPROVEMENTS SKETCH

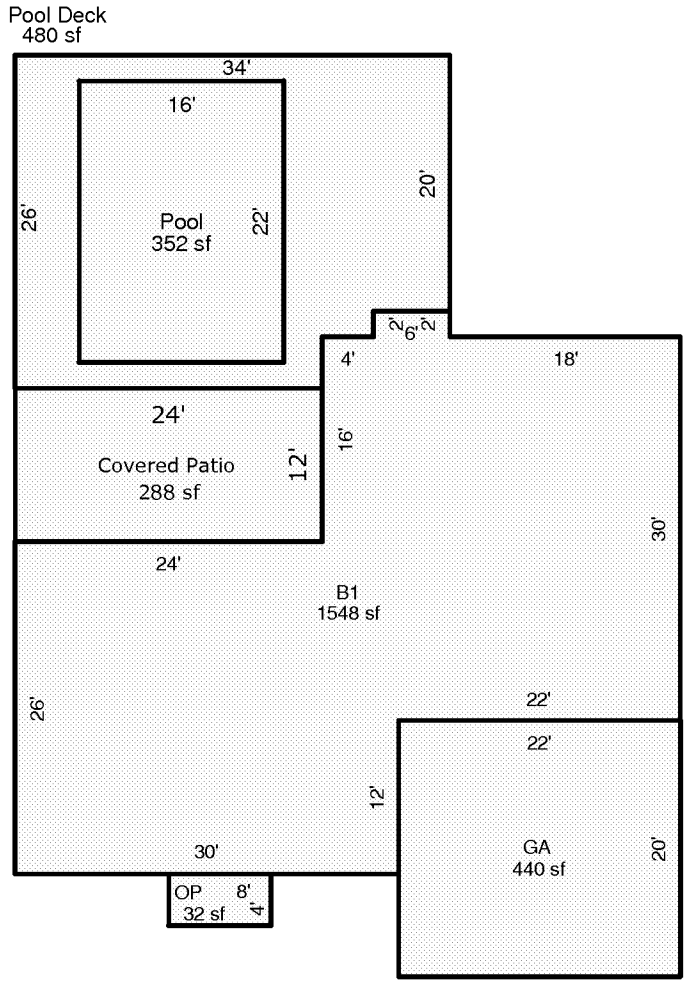

Scale: 1 = 15

AREA CALCULATIONS

AREA CALCULATIONS SUMMARY

Code	Description	Factor	Net Size	Perimeter	Net Totals
B1	B1	1.00	1548	192	1548
GA	GA	1.00	440	84	440
OP	OP	1.00	32	24	32
CVPRT	Covered Patio	1.00	288	72	288
PDECK	Pool Deck	1.00	480	120	480
POOL	Pool	1.00	352	76	352

Comment Table 1

--	--

Comment Table 2

Comment Table 3

--	--