

SKETCH/AREA TABLE ADDENDUM

DATE 7/18/11

RE # 2312562

SUBJECT	PARCEL ID 23-35-28-JN-174-3	CITY COCOA	COUNTY Brevard	STATE FL	ZIP 32927
	PERMIT # *				
	MARKET AREA 4	ADDRESS 6278 BALSAM ST			
	APPRAISER NAME JDI	BRANCH OFFICE TITUSVILLE			

IMPROVEMENTS SKETCH

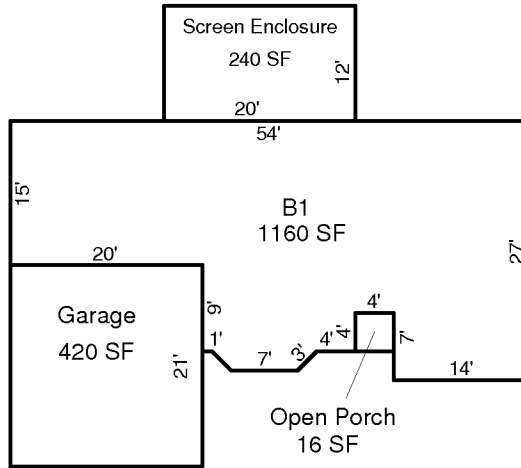

Scale: 1" = 12'

AREA CALCULATIONS

AREA CALCULATIONS SUMMARY

Code	Description	Factor	Net Size	Perimeter	Net Totals
B1	B1	1.00	1160	172	1160
GA	Garage	1.00	420	82	420
OP	Open Porch	1.00	16	16	16
SCREN	Screen Enclosure	1.00	240	64	240

Comment Table 1

--	--

Comment Table 2

Comment Table 3

--	--