

SKETCH/AREA TABLE ADDENDUM

DATE 9 JULY, 2010

RE # 2309796

SUBJECT

PARCEL ID 23 3523JM 75 21

CITY COCOA

COUNTY BREVARD

STATE FL

ZIP 32927

PERMIT # NONE

MARKET AREA 04

ADDRESS 4636 ALFERD ST.

APPRAISER NAME WHS

BRANCH OFFICE TITUSVILLE

IMPROVEMENTS SKETCH

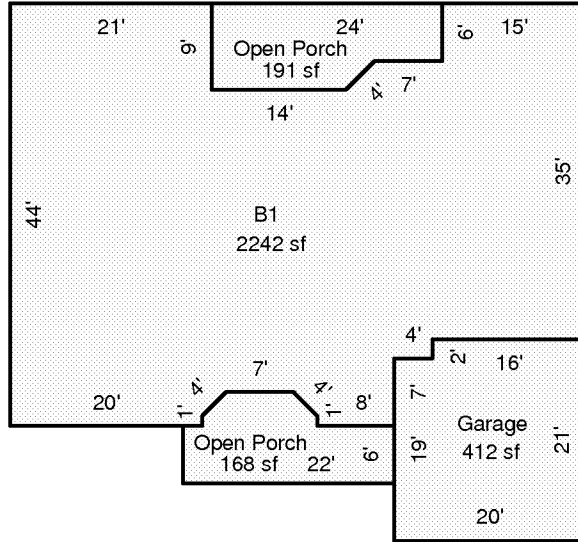

Scale: 1 = 20

AREA CALCULATIONS

AREA CALCULATIONS SUMMARY

Code	Description	Factor	Net Size	Perimeter	Net Totals
B1	B1	1.00	2242	228	2242
GA	Garage	1.00	412	82	412
OP	Open Porch	1.00	168	60	
	Open Porch	1.00	191	64	358

Comment Table 1

--	--

Comment Table 2

Comment Table 3

--	--