

SKETCH/AREA TABLE ADDENDUM

DATE 7/12/10

RE # 2306579

SUBJECT

PARCEL ID	23	3521JX	195	34			
CITY	COCOA	COUNTY	Brevard	STATE	FL	ZIP	32927
PERMIT #	NA						
MARKET AREA	04	ADDRESS	6160 CORSICA BLVD.				
APPRAISER NAME	JDI	BRANCH OFFICE	TITUSVILLE				

IMPROVEMENTS SKETCH

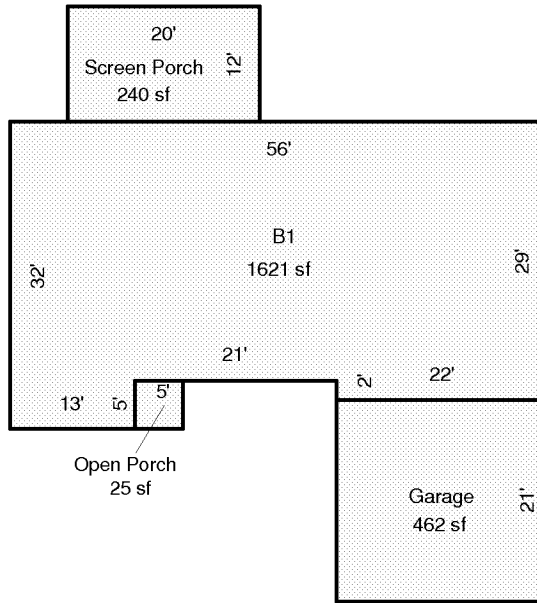

Scale: 1 = 20

AREA CALCULATIONS

AREA CALCULATIONS SUMMARY

Code	Description	Factor	Net Size	Perimeter	Net Totals
B1	B1	1.00	1621	180	1621
GA	Garage	1.00	462	86	462
OP	Open Porch	1.00	25	20	25
SP	Screen Porch	1.00	240	64	240

Comment Table 1

--

Comment Table 2

Comment Table 3

--	--