

SKETCH/AREA TABLE ADDENDUM

Parcel No 10/29/09

File No 2306174

Property Address 23-35-21-JN-172-39

City COCOA

County BREVARD

State FL

Zip 32927

Owner RECHECK

Client 04

Client Address 6193 CORNING RD

Appraiser Name JEC

Inspection Date VIERA

SUBJECT

IMPROVEMENTS SKETCH

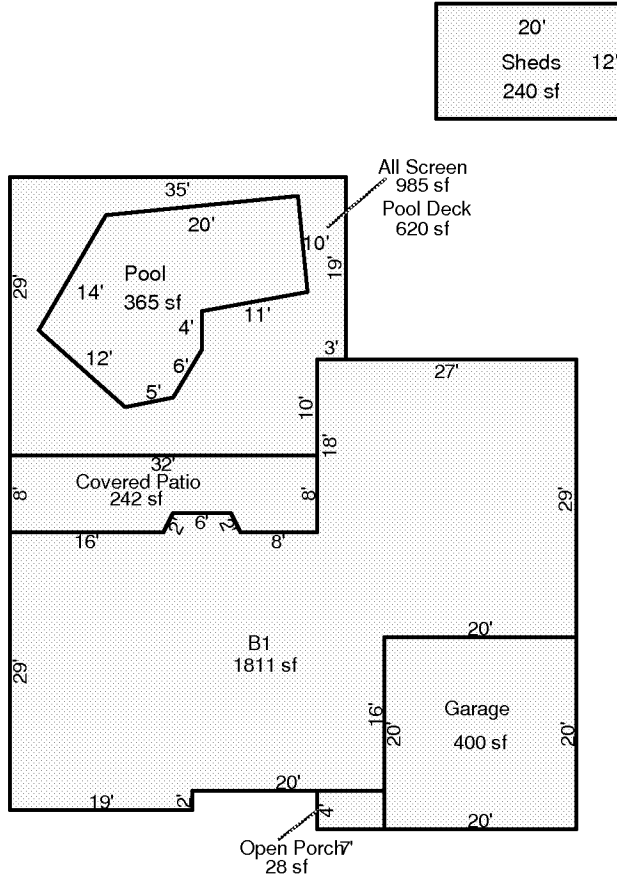

Scale: 1 = 20

AREA CALCULATIONS

AREA CALCULATIONS SUMMARY

Code	Description	Factor	Net Size	Perimeter	Net Totals
B1	B1	1.00	1811	214	1811
GA	Garage	1.00	400	80	400
OP	Open Porch	1.00	28	22	28
ALSCN	All Screen	1.00	985	128	985
CVPRT	Covered Patio	1.00	242	82	242
PDECK	Pool Deck	1.00	620	128	620
POOL	Pool	1.00	365	82	365
SHED	Sheds	1.00	240	64	240

Comment Table 1

--	--

Comment Table 2

Comment Table 3

--	--