

SKETCH/AREA TABLE ADDENDUM

DATE 22 SEPT. 2010

RE # 2305059

SUBJECT

PARCEL ID 23 3515JY 235 20
 CITY COCOA COUNTY BREVARD STATE FL ZIP 32927
 PERMIT # 09BC09047 ; 10BC00075 ; 10BC00527 ; 10BC01814
 MARKET AREA 04 ADDRESS 5230 EVERETT ST.
 APPRAISER NAME WHS BRANCH OFFICE TITUSVILLE

IMPROVEMENTS SKETCH

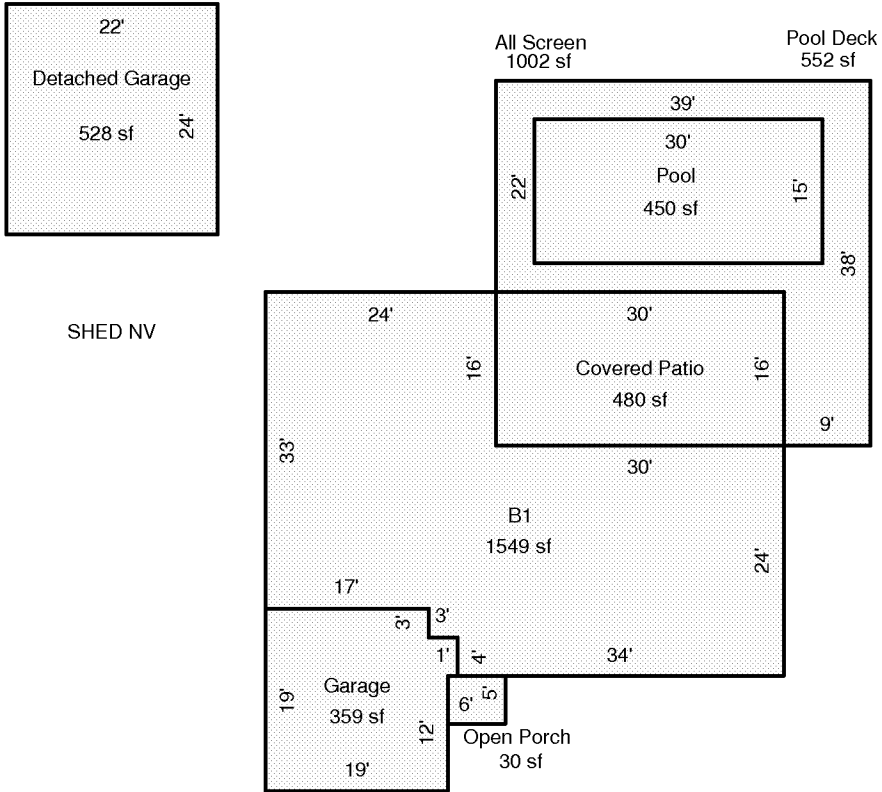

Scale: 1 = 20

AREA CALCULATIONS

AREA CALCULATIONS SUMMARY

Code	Description	Factor	Net Size	Perimeter	Net Totals
B1	B1	1.00	1549	188	1549
GA	Garage	1.00	359	78	359
OP	Open Porch	1.00	30	22	30
ALSCN	All Screen	1.00	1002	154	1002
CVPRT	Covered Patio	1.00	480	92	480
GRGD	Detached Garage	1.00	528	92	528
PDECK	Pool Deck	1.00	552	154	552
POOL	Pool	1.00	450	90	450

Comment Table 1

--	--

Comment Table 2

Comment Table 3

--	--