

SKETCH/AREA TABLE ADDENDUM

DATE 25 JULY, 2011

RE # 2304858

SUBJECT	PARCEL ID 23 3515JY 226 6	CITY COCOA	COUNTY BREVARD	STATE FL	ZIP 32927
	PERMIT # PICTO REVIEW	ADDRESS 7205 KIMBALL AVE.			
	MARKET AREA 04	BRANCH OFFICE TITUSVILLE			
	APPRaiser NAME WHS				

IMPROVEMENTS SKETCH

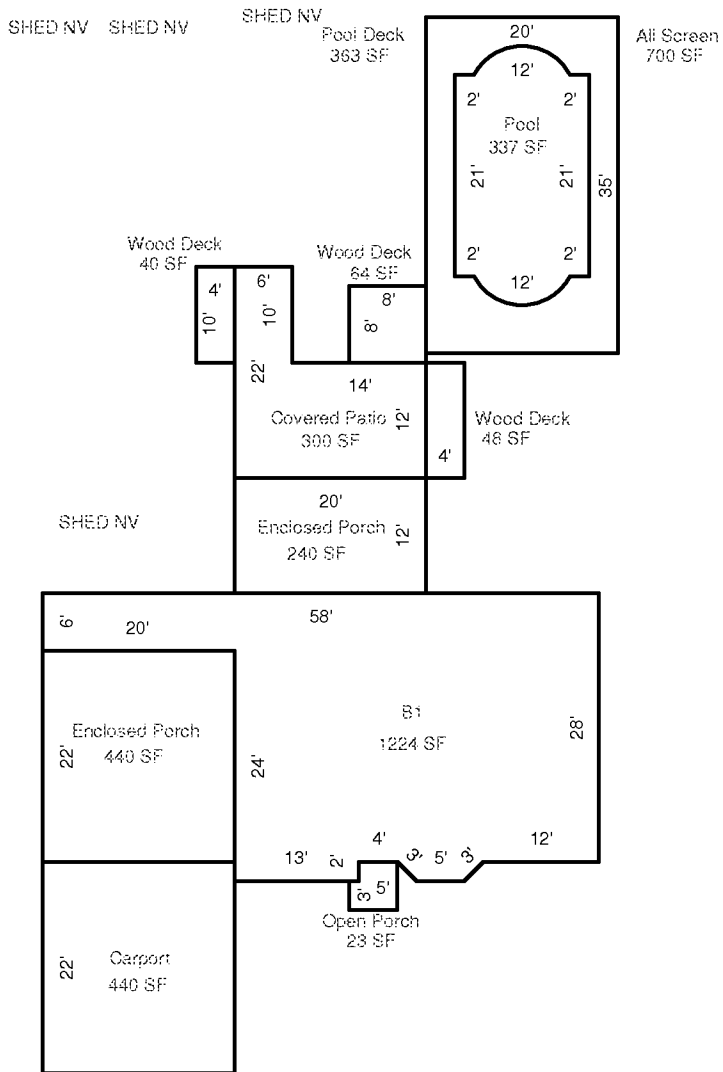

Scale: 1" = 12'

AREA CALCULATIONS

AREA CALCULATIONS SUMMARY

Code	Description	Factor	Net Size	Perimeter	Net Totals
B1	B1	1.00	1224	178	1224
EP	Enclosed Porch	1.00	440	84	
	Enclosed Porch	1.00	240	64	680
OP	Open Porch	1.00	23	20	23
ALSCN	All Screen	1.00	700	110	700
CRPRT	Carport	1.00	440	84	440
CVPRT	Covered Patio	1.00	300	84	300
PDECK	Pool Deck	1.00	363	110	363
POOL	Pool	1.00	337	74	337
WDECK	Wood Deck	1.00	48	32	
	Wood Deck	1.00	40	28	
	Wood Deck	1.00	64	32	152

Comment Table 1	
Comment Table 2	Comment Table 3