

# SKETCH/AREA TABLE ADDENDUM

DATE 11 MAY, 2010

RE # 2304718

SUBJECT	PARCEL ID 23 3515JY 221 10	CITY COCOA	COUNTY BREVARD	STATE FL	ZIP 32927
	PERMIT # 08BC00945				
	MARKET AREA 04	ADDRESS 5665 GRAHM ST.			
	APPRAISER NAME WHS	BRANCH OFFICE TITUSVILLE			

IMPROVEMENTS SKETCH

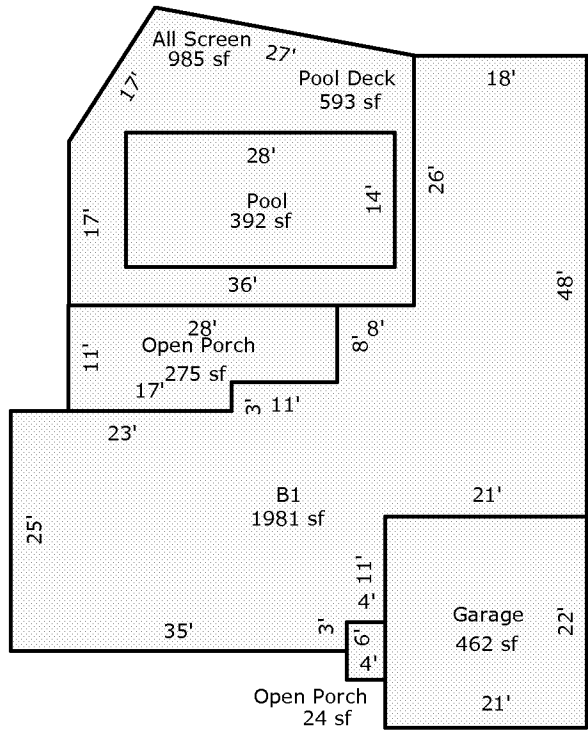

Scale: 1 = 20

AREA CALCULATIONS

### AREA CALCULATIONS SUMMARY

Code	Description	Factor	Net Size	Perimeter	Net Totals
B1	B1	1.00	1981	244	1981
GA	Garage	1.00	462	86	462
OP	Open Porch	1.00	24	20	
	Open Porch	1.00	275	78	299
ALSCN	All Screen	1.00	985	123	985
PDECK	Pool Deck	1.00	593	123	593
POOL	Pool	1.00	392	84	392

Comment Table 1

--	--

Comment Table 2

Comment Table 3

--	--