

SKETCH/AREA TABLE ADDENDUM

DATE 14 JULY, 2010

RE # 2304664

SUBJECT	PARCEL ID 23 3515JY 219 25
CITY COCOA	COUNTY BREVARD STATE FL ZIP 32927
PERMIT # NONE	
MARKET AREA 04	ADDRESS 5630 DATURA ST.
APPRAISER NAME WHS	BRANCH OFFICE TITUSVILLE

IMPROVEMENTS SKETCH

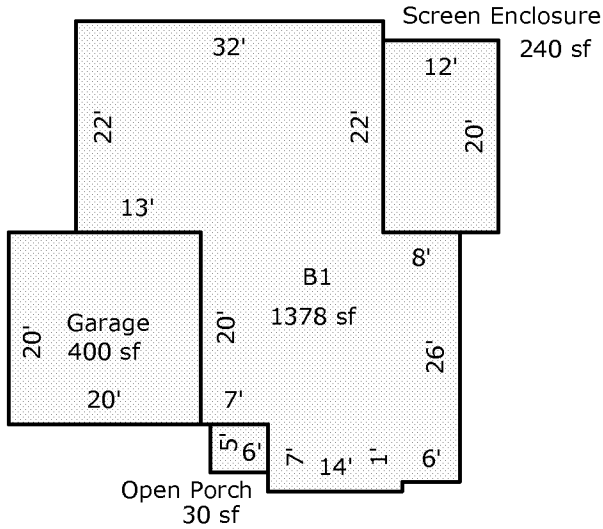

Scale: 1 = 20

AREA CALCULATIONS

AREA CALCULATIONS SUMMARY

Code	Description	Factor	Net Size	Perimeter	Net Totals
B1	B1	1.00	1378	178	1378
GA	Garage	1.00	400	80	400
OP	Open Porch	1.00	30	22	30
SCREEN	Screen Enclosure	1.00	240	64	240

Comment Table 1

Comment Table 2

Comment Table 3