

SKETCH/AREA TABLE ADDENDUM

Parcel No 16 JUNE, 2011

File No 2303206

Property Address 23 3514JZ 289 6

City COCOA

County BREVARD

State FL

Zip 32927

Owner 10BC08156 ; 10BC09540

Client 04

Client Address 7250 CAMILO RD.

Appraiser Name WHS

Inspection Date TITUSVILLE

SUBJECT

IMPROVEMENTS SKETCH

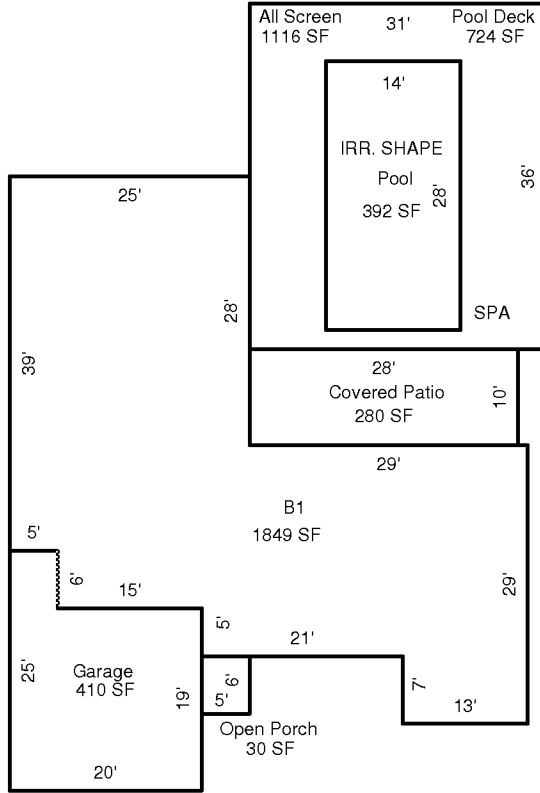

Scale: 1" = 12'

AREA CALCULATIONS

AREA CALCULATIONS SUMMARY

Code	Description	Factor	Net Size	Perimeter	Net Totals
B1	B1	1.00	1849	222	1849
GA	Garage	1.00	410	90	410
OP	Open Porch	1.00	30	22	30
ALSCN	All Screen	1.00	1116	134	1116
CVPRT	Covered Patio	1.00	280	76	280
PDECK	Pool Deck	1.00	724	134	724
POOL	Pool	1.00	392	84	392

Comment Table 1

--	--

Comment Table 2

Comment Table 3

--	--