

SKETCH/AREA TABLE ADDENDUM

DATE 22 FEB. 2011

RE # 2303018

SUBJECT	PARCEL ID 23 3514JZ 280 15	CITY COCOA	COUNTY BREVARD	STATE FL	ZIP 32927
	PERMIT # PICTO REVIEW				
	MARKET AREA 04	ADDRESS 7356 GLENWOOD RD.			
	APPRAISER NAME WHS	BRANCH OFFICE TITUSVILLE			
	SHED NV SHED NV				

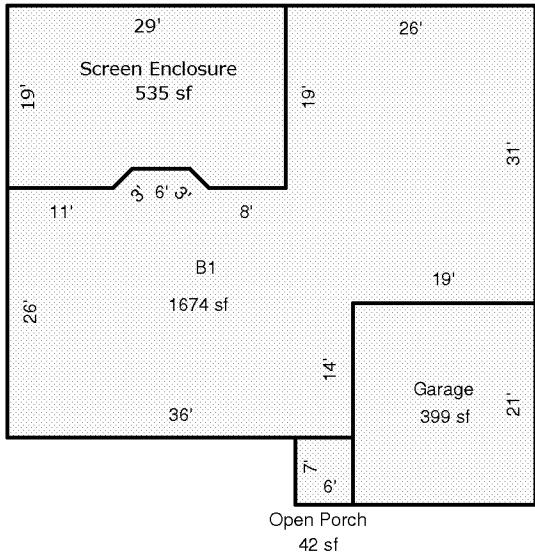

Scale: 1 = 20

AREA CALCULATIONS	AREA CALCULATIONS SUMMARY						Comment Table 1	
	Code	Description	Factor	Net Size	Perimeter	Net Totals		
	B1	B1	1.00	1674	202	1674		
	GA	Garage	1.00	399	80	399		
	OP	Open Porch	1.00	42	26	42		
SCREN	Screen Enclosure	1.00	535	98	535			
						Comment Table 2	Comment Table 3	