

SKETCH/AREA TABLE ADDENDUM

DATE 14 MAR. 2011

RE # 2106054

SUBJECT	PARCEL ID 21 352951 8
CITY TITUSVILLE	COUNTY BREVARD STATE FL ZIP 32796
PERMIT # PICTO REVIEW	
MARKET AREA 03	ADDRESS 3095 ROSEMARIE DR.
APPRAISER NAME WHS	BRANCH OFFICE TITUSVILLE

IMPROVEMENTS SKETCH

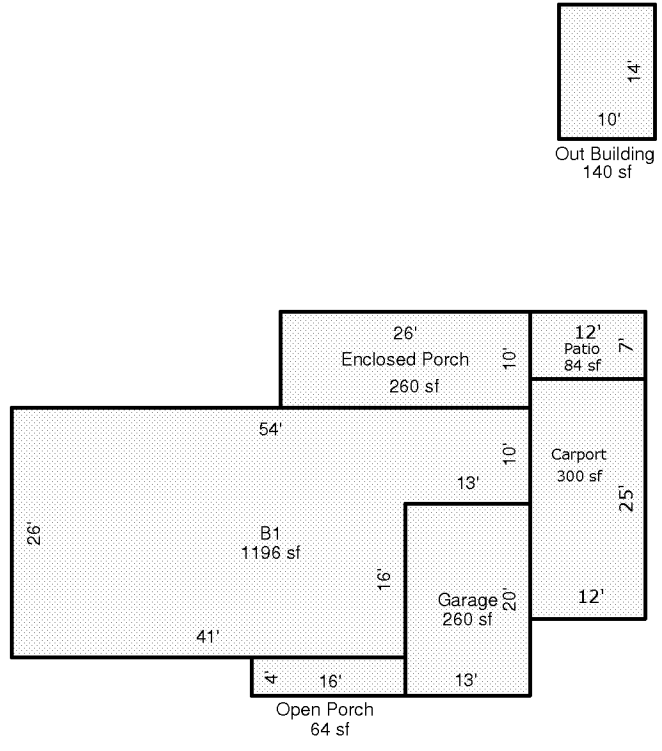

Scale: 1 = 20

AREA CALCULATIONS

AREA CALCULATIONS SUMMARY					
Code	Description	Factor	Net Size	Perimeter	Net Totals
B1	B1	1.00	1196	160	1196
GA	Garage	1.00	260	66	260
EP	Enclosed Porch	1.00	260	72	260
OP	Open Porch	1.00	64	40	64
PT	Patio	1.00	84	38	84
CRPRT	Carport	1.00	300	74	300
OBLD	Out Building	1.00	140	48	140

Comment Table 1	
Comment Table 2	Comment Table 3