

SKETCH/AREA TABLE ADDENDUM

DATE 21 APR. 20100

RE # 2103347

SUBJECT

PARCEL ID 21 351700 306				
CITY MIMS	COUNTY BREVARD	STATE FL	ZIP 32754	
PERMIT # NONE				
MARKET AREA 01	ADDRESS 3014 MORTIMER LN.			
APPRAISER NAME WHS	BRANCH OFFICE TITUSVILLE			

IMPROVEMENTS SKETCH

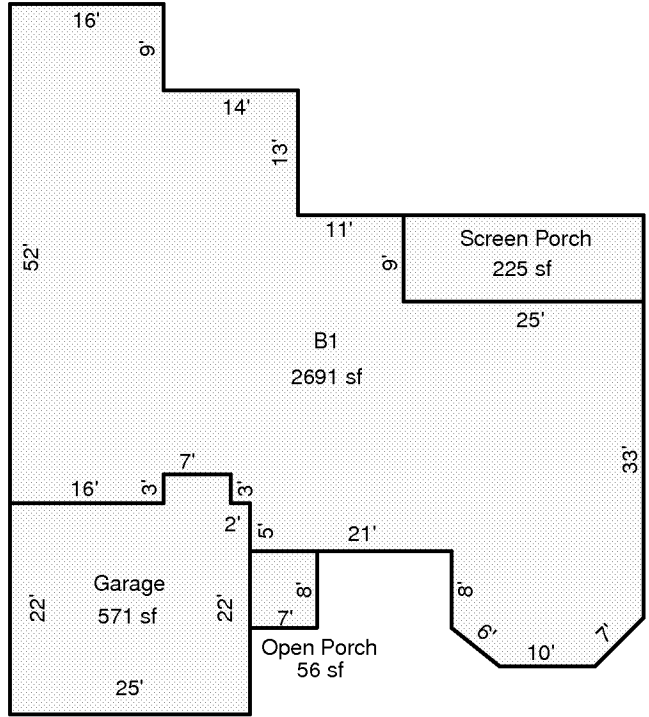

Scale: 1 = 20

AREA CALCULATIONS

AREA CALCULATIONS SUMMARY

Code	Description	Factor	Net Size	Perimeter	Net Totals
B1	B1	1.00	2691	270	2691
GA	Garage	1.00	571	100	571
OP	Open Porch	1.00	56	30	56
SP	Screen Porch	1.00	225	68	225

Comment Table 1

Comment Table 1	

Comment Table 2

Comment Table 3

Comment Table 2	Comment Table 3